



# Wood & Pellet Products

Pocket  
01\_2022 EN

PRESTIGE  
Line

Evolution  
*line*

# INDEX



## Wood

STOVES .....	2
COOKER .....	9
FIREPLACE .....	11

## Pellet

STOVES .....	14
--------------	----



## Pellet stoves

VENTILATED STOVES .....	19
DUCTED STOVES .....	33
HEATING STOVES .....	42

## Pellet boilers

BOILERS .....	49
---------------	----

TECHNOLOGY .....	52
------------------	----

GENERAL PRODUCTS TABLE OF CONTENTS .....	53
---	----

CERTIFICATES .....	55
--------------------	----

NOTE .....	58
ENERGY LABEL .....	58
LEGEND .....	58

Trademark and copyright:

All brands, pictures, information and photos, products, advertisements and all other features displayed in this catalogue are the exclusive property of La Nordica S.p.A. / Extraflame S.p.A.

W  
O  
O  
D

PRESTIGE

Line

PERFECT SYMBIOSIS

OF DESIGN

AND WARMTH

**A+** | 7,5 kW-N | 215 m<sup>3</sup>

## CHARACTERISTICS



## ECODESIGN

Download  
Technical Sheet



SCAN ME



## TECHNICAL DATA

**Nominal power**  
7,5 kW-N

**Efficiency**  
86,5 %

**Hourly consumption**  
2,0 kg/h

**Dimensions (LxHxD)**  
537 x 1127 x 490 mm

**Net weight**  
170 kg

**Fumes flue diameter (Ø)**  
130 mm T

**Hearth opening size (LxH)**  
270 x 375 mm

**Hearth dimensions (LxHxD)**  
295 x 420 x 310 mm

**Wood length (max)**  
30 cm

## TECHNOLOGY



Hearth in Nordiker®



Post combustion



Doors in cast iron



Glass cleaning system



Direct outdoor air intake (BBC)

## COLOUR CHOICES

External facing in majolica



Bordeaux



White Infinity



Internal facing of the hearth in cast iron and Nordiker

# LIÙ - PIETRA

Wood burning stove

PRESTIGE

Line

**A+** | 7,5 kW-N | 215 m<sup>3</sup>

## CHARACTERISTICS



## TECHNICAL DATA

**Nominal power**  
7,5 kW-N

**Efficiency**  
86,5 %

**Hourly consumption**  
2,0 kg/h

**Dimensions (LxHxD)**  
528 x 1107 x 508 mm

**Net weight**  
201 kg

**Fumes flue diameter (Ø)**  
130 mm T

**Hearth opening size (LxH)**  
270 x 375 mm

**Hearth dimensions (LxHxD)**  
295 x 420 x 310 mm

**Wood length (max)**  
30 cm

## TECHNOLOGY



## ECODESIGN

Download  
Technical Sheet



SCAN ME



## COLOUR CHOICES

Finish in natural stone carved from a single block



Natural stone



Internal facing of the hearth in cast iron and Nordiker

N.B. Enameled cast iron, when used correctly, has almost an unlimited life and requires minimal maintenance.

# TAHITI

Cast iron wood burning stove

# TAHITI EPS

Wood stove with heat recovery system

PRESTIGE

Line

## TAHITI

**A+** | 7,7 kW-N | 220 m<sup>3</sup>

## TAHITI EPS

**A+** | 8,0 kW-N | 229 m<sup>3</sup>

## CHARACTERISTICS



## TECHNICAL DATA

### Nominal power

Tahiti 7,7 kW-N  
Tahiti EPS 8,0 kW-N

### Efficiency

Tahiti 81,8 %  
Tahiti EPS 87,6 %

### Hourly consumption

2,2 kg/h

### Dimensions (LxHxD)

Tahiti 746 x 894 x 483 mm  
Tahiti EPS 746 x 1373 x 483 mm

### Net weight

Tahiti 150 kg  
Tahiti EPS 154 kg

### Fumes flue diameter (Ø)

150 mm T

### Hearth opening size (LxH)

532 x 212 mm

### Hearth dimensions (LxHxD)

585 x 290 x 255 mm

### Wood length (max)

50 cm

## TECHNOLOGY



Hearth in Nordiker



Post combustion



Doors in cast iron



Glass cleaning system



Direct outdoor air intake (BBC)

## ECODESIGN

Download  
Technical Sheet  
Tahiti



SCAN ME

Download  
Technical Sheet  
Tahiti EPS



SCAN ME



## COLOUR CHOICES

Finish entirely in enamelled cast iron



Tahiti  
Anthracite black

Tahiti EPS  
Anthracite black

## STANDARD EQUIPMENT - TAHITI EPS



### EPS System

Model with heat recovery system



Front and side loading door

N.B. Enamelled cast iron, when used correctly, has almost an unlimited life and requires minimal maintenance.

# ORIANA

Ventilated or ducted wood burning stove

PRESTIGE

Line

**A+** | 8,3 kW-N | 238 m<sup>3</sup>

## CHARACTERISTICS

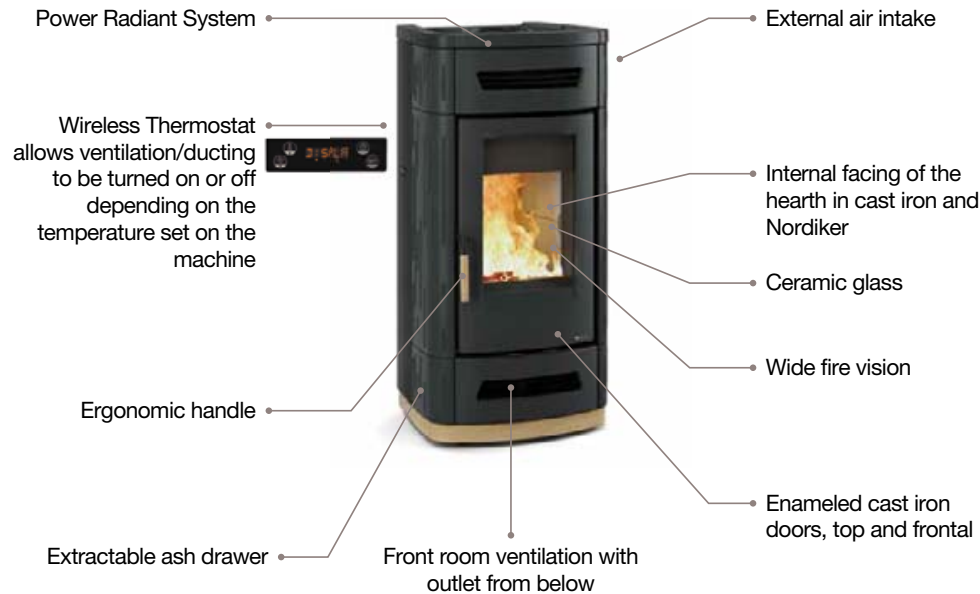

## TECHNICAL DATA

**Nominal power**  
8,3 kW-N

**Efficiency**  
85,0 %

**Hourly consumption**  
2,3 kg/h

**Dimensions (LxHxD)**  
636 x 1313 x 554 mm

**Net weight**  
NE 239 kg  
PT 264 kg  
BIN 228 kg

**Fumes flue diameter (Ø)**  
150 mm T

**Hearth opening size (LxH)**  
326 x 347 mm

**Hearth dimensions (LxHxD)**  
300 x 400 x 360 mm

**Wood length (max)**  
30 cm

**Power absorption**  
35 W

## TECHNOLOGY



## ECODESIGN



Download  
Technical Sheet



SCAN ME

## COLOUR CHOICES

Finish in cast iron, majolica or natural stone.  
Lower plinth and handle in natural wood.



## ONE STOVE, TWO HEATING MODES

Possibility to convert the stove - during installation - into a ducted product with a single rear 100 mm outlet



ATTENTION: One configuration excludes the other, therefore the stove can work with either ventilation only or ducting only.

## WIRELESS THERMOSTAT



Wireless Thermostat (standard), allows ventilation/ducting to be turned on or off depending on the temperature set on the machine

# DANTE

Wood stove with heat recovery system

PRESTIGE

Line

**A+** | 8,8 kW-N | 252 m<sup>3</sup>

## CHARACTERISTICS

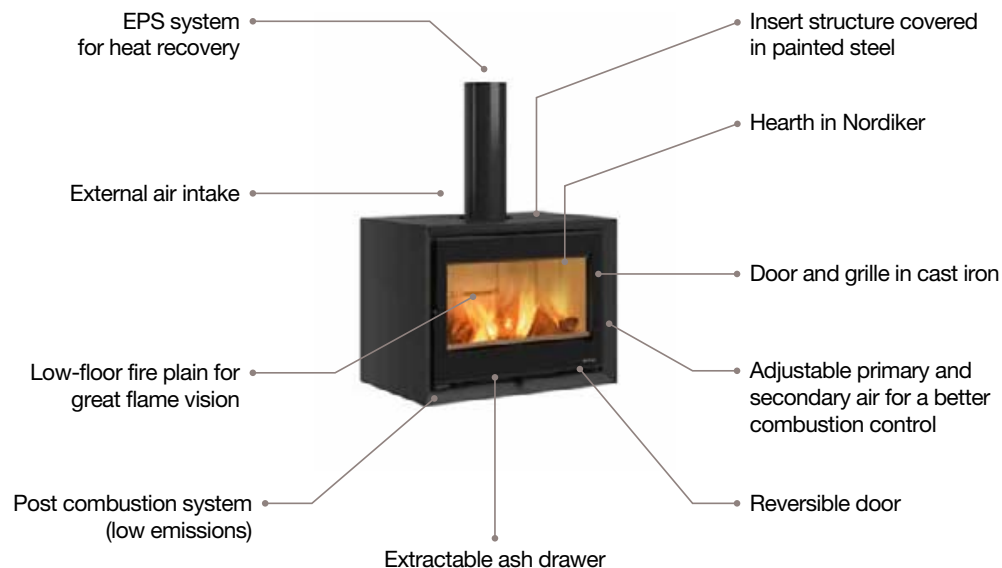

## TECHNICAL DATA

**Nominal power**  
8,8 kW-N

**Efficiency**  
85,5 %

**Hourly consumption**  
2,4 kg/h

**Dimensions (LxHxD)**  
822 x 1055 x 550 mm

**Net weight**  
158 kg

**Fumes flue diameter (Ø)**  
160 mm T

**Hearth opening size (LxH)**  
626 x 278 mm

**Hearth dimensions (LxHxD)**  
652 x 295 x 350 mm

**Wood length (max)**  
30 cm

## TECHNOLOGY



Hearth in Nordiker®



Post combustion



Doors in cast iron



Glass cleaning system



Direct outdoor air intake (BBC)

## ECODESIGN

Download  
Technical Sheet



SCAN ME



## COLOUR CHOICES

High temperature painted steel covering - Matte black

**DANTE WITH BENCH (optional element)**  
Examples of combinations



**Dimensions with bench (LxHxD)**

1490 x 1525 x 540 mm

## STANDARD EQUIPMENT



**EPS System**  
Model with heat recovery system

## OPTIONAL



**Bench Matte black**  
LxHxD 1490x470x540 mm  
53,5 Kg



# DANTE CON PORTALEGNA

Wood stove with heat recovery system

PRESTIGE

Line

**A+** | 8,8 kW-N | 252 m<sup>3</sup>

## CHARACTERISTICS



## TECHNICAL DATA

**Nominal power**  
8,8 kW-N

**Efficiency**  
85,5 %

**Hourly consumption**  
2,4 kg/h

**Dimensions (LxHxD)**  
822 x 1480 x 553 mm

**Net weight**  
183 kg

**Fumes flue diameter (Ø)**  
160 mm T

**Hearth opening size (LxH)**  
626 x 278 mm

**Hearth dimensions (LxHxD)**  
652 x 295 x 350 mm

**Wood length (max)**  
30 cm

## TECHNOLOGY



Hearth in Nordiker



Post combustion



Doors in cast iron



Glass cleaning system



Direct outdoor air intake (BBC)

## ECODESIGN



Download  
Technical Sheet



SCAN ME

## COLOUR CHOICES

High temperature painted steel covering - Matte black



## STANDARD EQUIPMENT



**EPS System**  
Model with heat recovery system

# NOVA FORNO

Wood stove with oven

PRESTIGE

Line

New 2022

**A+** | 11,8 kW-N | 338 m<sup>3</sup>

Download  
technical data sheet



SCAN ME

## CHARACTERISTICS



## ECODESIGN



## TECHNICAL DATA

**Nominal power (min. - max.)**

11,8 kW-N

**Efficiency**

86,4 %

**Hourly consumption**

3,2 kg/h

**Dimensions (WxHxD)**

559 x 1496 x 569 mm

**Net weight**

256 kg

**Smoke outlet diameter (Ø)**

150 mm U

**Hearth opening size (WxH)**

315 x 285 mm

**Hearth size (WxHxD)**

357 x 450 x 362 mm

**Oven size (WxHxD)**

330 x 300 x 370 mm

**Wood, max. length**

30 cm

## TECHNOLOGY



Nordiker® hearth



Post combustion



Cast iron doors



Glass cleaning system



Direct external air inlet (BBC)

## FINISHES

Majolica cladding



Matt white



Burgundy

## STANDARD EQUIPMENT



**ENAMELLED OVEN PAN (1 piece)**



**CHROME PLATED OVEN GRILL (1 piece)**

**A+** | 8,7 kW-N | 249 m<sup>3</sup>

## CHARACTERISTICS



## TECHNICAL DATA

**Nominal power (min-max)**  
8,7 kW-N

**Efficiency**  
89,1 %

**Hourly consumption**  
2,3 kg/h

**Dimensions (LxHxD)**  
1050 x 865 x 670 mm  
(without food warmer)

**Net weight**  
217 kg  
(without food warmer)

**Fumes flue diameter (Ø)**  
150 mm B/T

**Hearth opening size (LxH)**  
240 x 185 mm

**Hearth dimensions (LxHxD)**  
270 x 287 x 455 mm

**Dimensione Forno (LxHxD)**  
436 x 418 x 430 mm

**Wood length (max)**  
30 cm

## TECHNOLOGY



## ECODESIGN

Download  
Technical Sheet



SCAN ME



## COLOUR CHOICES

Finish in enamelled steel and majolica



Bordeaux

White Infinity

## STANDARD EQUIPMENT

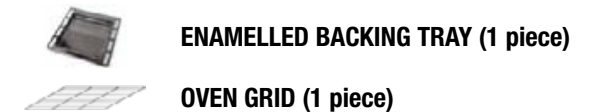

## OPTIONAL

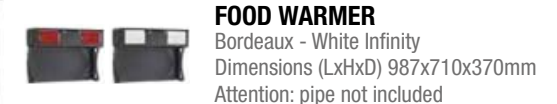

# ALASKA

Wood-burning cooker

PRESTIGE

Line

New 2022

**A+** | 12,0\*\* kW-N | 344\*\* m<sup>3</sup>

ECODESIGN\*\*

Download  
technical data sheet



SCAN ME

## CHARACTERISTICS



## TECHNICAL DATA

Nominal power (min. - max.)

12,0 kW-N \*\*

Efficiency

88,6 % \*\*

Hourly consumption

3,2 kg/h \*\*

Dimensions (WxHxD)

1280 x 860 x 660 mm \*\*

Net weight

339 kg \*\*

Smoke outlet diameter (Ø)

150 mm R/U \*\*

Hearth opening size (WxH)

402 x 283 mm \*\*

Hearth size (WxHxD)

400 x 345 x 460 mm \*\*

Oven size (WxHxD)

436 x 418 x 430 mm \*\*

Wood, max. length

30 cm \*\*

## TECHNOLOGY



Nordiker hearth



Post combustion



Cast iron doors



Glass cleaning system



Direct external air inlet (BBC)

## FINISHES

Cast iron and enamelled steel cladding



Glazed black

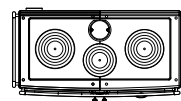

Three-ring plate

## STANDARD EQUIPMENT



ENAMELLED OVEN PAN (1 piece)



STAINLESS STEEL GRILL (1 piece)



CHROME PLATED OVEN GRILL (1 piece)

## OPTIONAL



CHROME PLATED HANDRAIL AND TERMINALS

# MONOBLOCCO 3LC

Wood-burning monoblock for fireplaces

PRESTIGE  
Line

New 2022

**A+** | 10,5\*\* kW-N | 378\*\* m<sup>3</sup>

Download  
technical data sheet



SCAN ME

## CHARACTERISTICS

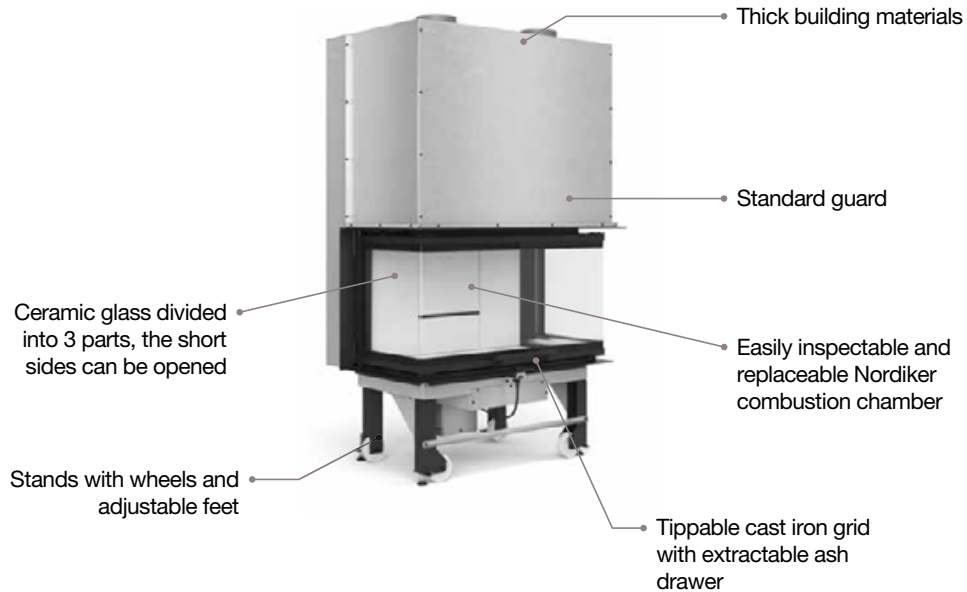

## ECODESIGN\*\*



## TECHNICAL DATA

**Nominal power**  
10,5 kW-N \*\*

**Efficiency**  
> 80,0 % \*\*

**Hourly consumption**  
3,8 kg/h \*\*

**Dimensions (WxHxD)**  
1034 x 1642-1682 x 654 mm \*\*

**Net weight**  
220 kg \*\*

**Smoke outlet diameter (Ø)**  
200 mm \*\*

**Hearth opening size (WxH)**  
800 x 350 mm \*\*

**Hearth size (WxHxD)**  
730 x 480 x 325 mm \*\*

**Wood, max. length**  
50 cm \*\*

## TECHNOLOGY



Nordiker®



Post combustion



Glass cleaning system



Direct external air inlet (BBC)

## FINISHES



## DETAIL



Door movement with new smooth & soft system (moves while lifting)

\*\* Technical data may be subject to changes, approval pending

# MONOBLOCCO 1000 EVO

Monoblocco for fireplaces

PRESTIGE

Line

**A+** | 12,3 kW-N | 352 m<sup>3</sup>

## CHARACTERISTICS

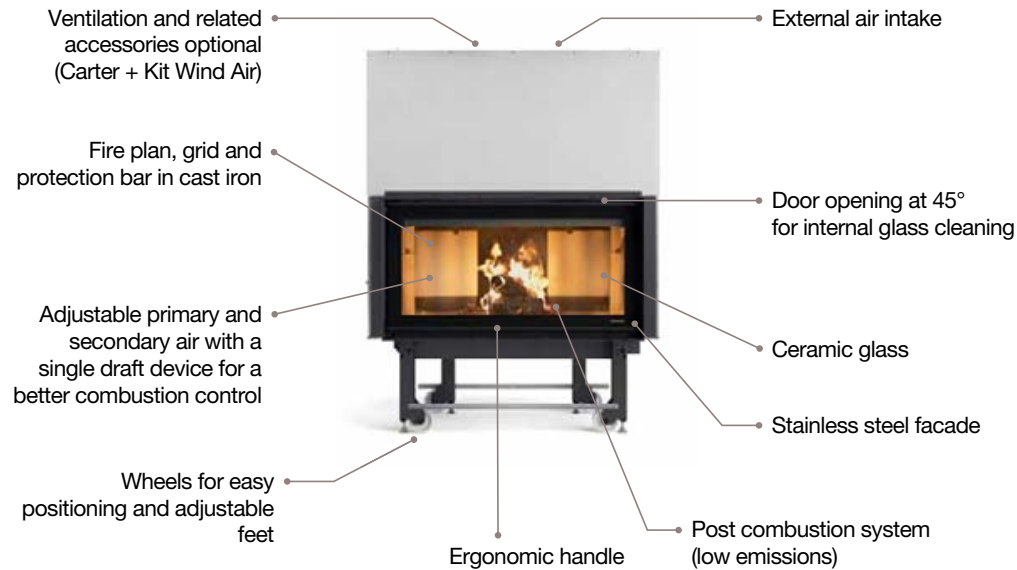

## ECODESIGN

Download  
Technical Sheet



SCAN ME



## TECHNICAL DATA

**Nominal power**  
12,3 kW-N

**Efficiency**  
85,6 %

**Hourly consumption**  
3,4 kg/h

**Dimensions (LxHxD)**  
1136 x 1512-1552 x 597 mm

**Net weight**  
292 kg

**Fumes flue diameter (Ø)**  
200 mm T

**Hearth opening size (LxH)**  
870 x 345 mm

**Hearth dimensions (LxHxD)**  
840 x 447 x 340 mm

**Wood length (max)**  
30 cm

## TECHNOLOGY

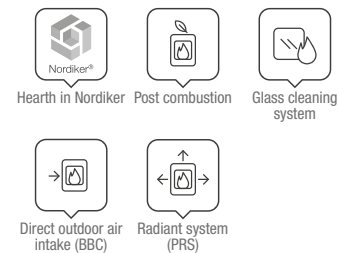

## COLOUR CHOICES



## OPTIONAL



**Inox surroundings kit**



**Casing**

Required item for installation of traditional ventilation outlets or Kit "Wind Air"



**"Wind Air" kit**



**Shade diffuser**

**Wave diffuser**

# MONOBLOCCO 90PA

Wood-burning monoblock for fireplaces



New 2022

**A+** | 13 kW-N | 378 m<sup>3</sup>

## CHARACTERISTICS

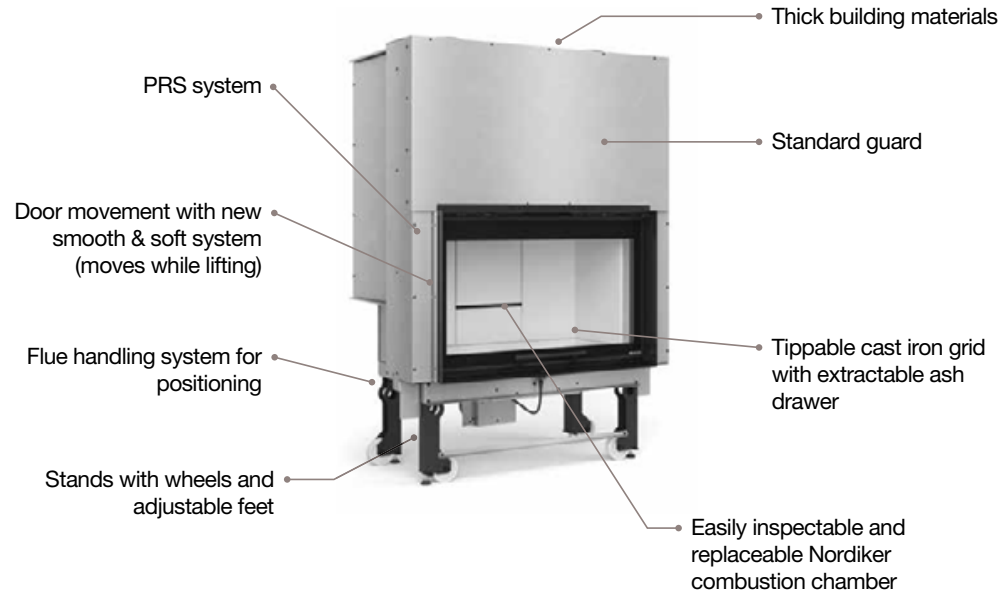

## TECHNICAL DATA

**Nominal power**  
13,2 kW-N

**Efficiency**  
86,5 %

**Hourly consumption**  
3,6 kg/h

**Dimensions (WxHxD)**  
1105 x 1590-1630 x 650 mm

**Net weight**  
320 kg

**Smoke outlet diameter (Ø)**  
180 mm

**Hearth opening size (WxH)**  
830 x 350 mm

**Hearth size (WxHxD)**  
815 x 480 x 325 mm

**Wood, max. length**  
50 cm

## TECHNOLOGY

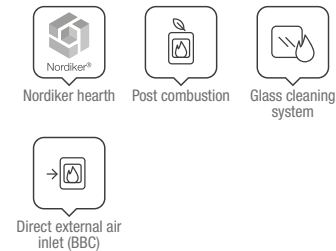

## ECODESIGN

Download technical data sheet



SCAN ME



## FINISHES



## OPTIONAL



**Stainless steel frame kit**



**“Wind Air” Kit**



**Shade diffuser**



**Wave diffuser**



PRESTIGE

Line

PERFECT SYMBIOSIS

OF DESIGN

AND WARMTH



**A+** | 7,0 kW-N | 201 m<sup>3</sup>

## CHARACTERISTICS



- Output smoke outlet possibilities: rear
- Radiant surface heat exchanger
- Ergonomic handle
- Extractable burn pot for easy cleaning

## ECODESIGN



Download  
Technical Sheet



SCAN ME

## TECHNICAL DATA

**Nominal power (min-max)**  
2,5 - 7,0 kW-N

**Efficiency (min-max)**  
92,2 - 90,9 %

**Hourly consumption (min-max)**  
0,6 - 1,6 kg/h

**Dimensions (LxHxD)**  
456 x 924 x 555 mm

**Net weight**  
86 kg

**Fumes flue diameter (Ø)**  
80 mm B

**Tank total capacity**  
~15 kg / ~24 ℓ

**Power absorption (min-max)**  
30 - 60 W

## TECHNOLOGY

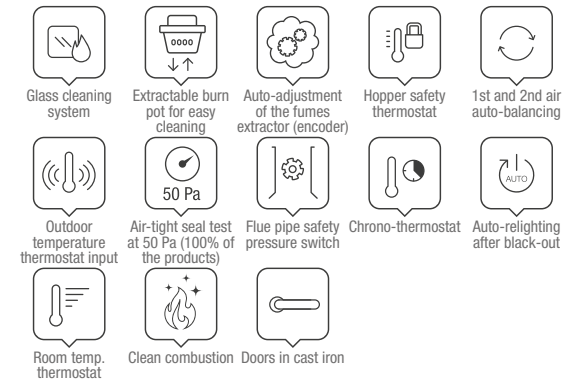

## COLOUR CHOICES

High temperature painted steel covering



Ivory

Black

Bronze

## STANDARD EQUIPMENT



**REMOTE CONTROL**  
Backlit IR touch remote control



**BLACK LCD**

New 2022

**A+** | **8,0\*\* kW-N** | **230\*\* m<sup>3</sup>**

## CHARACTERISTICS



- Smoke discharge outlet option: rear, upper
- New “5-star” brazier + EGR
- Radiant surface heat exchanger
- Removable ash compartment
- Home automation integration with “Alexa” (Amazon). N.B. only with “Grey label” WiFi module – optional – and using the App Total Control 3.0. Service and “Alexa” device (Amazon) not included
- FPC – An innovative adaptive system for regulating and maintaining air combustion constant over time
- Easy Control
- Self Control
- Easy Setup

## ECODESIGN\*\*

Download technical data sheet



SCAN ME



## TECHNICAL DATA

**Nominal power (min. - max.)**

2,5 - 8,0 kW-N \*\*

**Efficiency (min. - max.)**

93,1 - 91,2 % \*\*

**Hourly consumption (min. - max.)**

0,6 - 1,8 kg/h \*\*

**Dimensions (WxHxD)**

496 x 1014 x 573 mm \*\*

**Net weight**

99 kg \*\*

**Smoke outlet diameter (Ø)**

80 mm U/R \*\*

**Total tank capacity**

~15 kg / ~24 ℓ \*\*

**Electric consumption (min. - max.)**

30 - 60 W \*\*

## TECHNOLOGY



Glass cleaning system



Removable brazier for easy cleaning



Self-adjusting smoke extractor (encoder)



Tank safety thermostat



Primary and secondary air self-balancing



External ambient thermostat connection



Airtightness test at 50 pa (100% products)



Flue safety pressure switch



Programmable thermostat



Automatic reignition after blackout



Ambient temperature thermostat



Clean combustion



Cast iron doors

## FINISHES

Black painted steel cladding and ceramic or stone front panel



Black



Dove grey



Natural stone

## STANDARD EQUIPMENT



**REMOTE CONTROL**

Backlit IR Touch remote control



**BLACK LCD**

# MIRKA PLUS

Ducted pellet stove

PRESTIGE  
Line

New 2022

**A+** | 8,0\*\* kW-N | 230\*\* m<sup>3</sup>

Download  
technical data sheet



SCAN ME

## CHARACTERISTICS



- Smoke discharge outlet option: rear, upper
- New "5-star" brazier + EGR
- Ducting with dedicated motor up to 8 metres, thermostatically controlled and removable + AIR ZONE CONTROL
- Radiant surface heat exchanger
- Removable ash compartment
- Home automation integration with "Alexa" (Amazon). N.B. only with "Grey label" WiFi module – optional – and using the App Total Control 3.0. Service and "Alexa" device (Amazon) not included
- FPC – An innovative adaptive system for regulating and maintaining air combustion constant over time
- Easy Control
- Self Control
- Easy Setup

UP TO 8 METRES OF DUCTS through one back output Ø80 (excludable)

## ECODESIGN\*\*



## TECHNICAL DATA

**Nominal power (min. - max.)**  
2,5 - 8,0 kW-N \*\*

**Efficiency (min. - max.)**  
90,8 - 90,8 % \*\*

**Hourly consumption (min. - max.)**  
0,6 - 1,8 kg/h \*\*

**Dimensions (WxHxD)**  
496 x 1014 x 573 mm \*\*

**Net weight**  
103 kg \*\*

**Smoke outlet diameter (Ø)**  
80 mm U/R \*\*

**Total tank capacity**  
~15 kg / ~24 ℓ \*\*

**Electric consumption (min. - max.)**  
30 - 60 W \*\*

## TECHNOLOGY

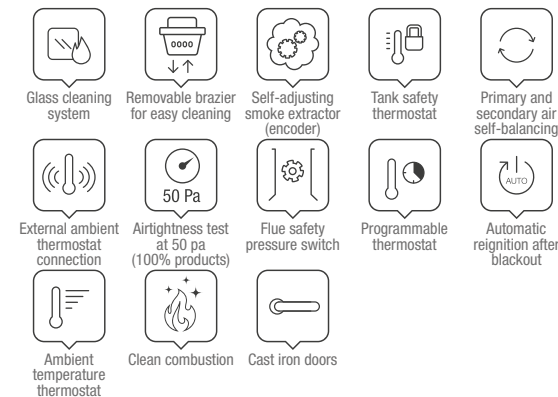

## FINISHES

Black painted steel cladding and ceramic or stone front panel



Black

Dove grey

Natural stone

## STANDARD EQUIPMENT



**REMOTE CONTROL**  
Backlit IR Touch remote control



**BLACK LCD**

\*\* Technical data may be subject to changes, approval pending

Evolution  
*line*

THE TECHNOLOGICAL

REVOLUTION OF HEAT



EV  
EN  
TI  
LA  
TE

PE  
LL  
TE  
S  
FO  
TS

Evolution  
*Life*

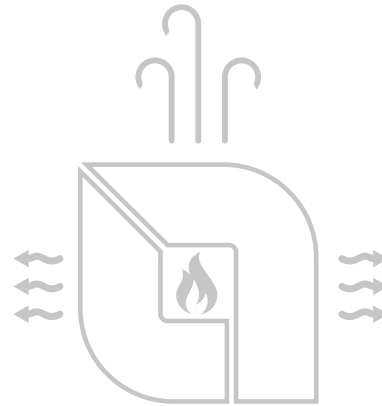

Totally Air-tight

Home control Solution



### AIR-TIGHT

**SAFE:** Air-tight combustion chamber and tank: **technology** and innovation at the service of your safety



### THE LATEST GENERATION IGNITION SYSTEM

**FAST:** For immediate warmth in your home, always and everywhere



### HOME CONTROL SOLUTION

**INNOVATIVE:** Always in contact with your stove, even when you are away from home



### OPTIMISED COMBUSTION

**EFFICIENT:** Reduces the waiting time for relighting, ensuring optimal combustion



### CONTROL WITH MULTI-FUNCTION RADIO REMOTE CONTROL HANDHELD DEVICE

**AGILE:** All the control functions of the stove, but also with a remote thermostat

# MOIRA EVO

Ventilated and **hermetic** pellet stove

Evolution  
*Life*

**A+** | 7,0 kW-N | 200 m<sup>3</sup>

## CHARACTERISTICS



- Output smoke outlet possibilities: rear
- Emergency module
- Extractable burn pot for easy cleaning

## ECODESIGN



Download  
Technical Sheet



SCAN ME

## TECHNICAL DATA

**Nominal power (min-max)**  
2,5 - 7,0 kW-N

**Efficiency (min-max)**  
94,3 - 90,4 %

**Hourly consumption (min-max)**  
0,6 - 1,6 kg/h

**Dimensions (LxHxD)**  
463 x 893 x 528 mm

**Net weight**  
84 kg

**Fumes flue diameter (Ø)**  
80 mm B

**Tank total capacity**  
~11 kg / ~18 l

**Power absorption (min-max)**  
30 - 60 W

## TECHNOLOGY

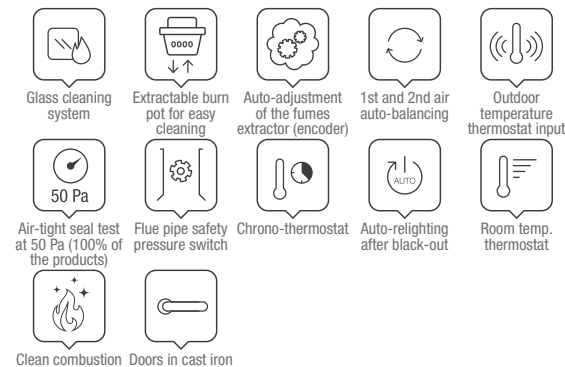

## COLOUR CHOICES

High temperature painted steel covering and majolica top cover



Bordeaux

White

Black

## STANDARD EQUIPMENT



### REMOTE CONTROL

Control with radio-controlled "hand-held" device, with thermostat function

New 2022

**A+** | 7,0\*\* kW-N | 200\*\* m<sup>3</sup>

## CHARACTERISTICS



- Smoke discharge outlet option: rear
- Removable brazier for easy cleaning
- Removable ash compartment
- Room temperature control with AUTOMATIC function
- Home automation integration with "Alexa"
- Easy Control
- Self Control
- Easy Setup



Tab for opening the door

## ECODESIGN\*\*

Download technical data sheet



SCAN ME



## TECHNICAL DATA

Nominal power (min. - max.)

2,5 - 7,0 kW-N \*\*

Efficiency (min. - max.)

94,3 - 90,4 % \*\*

Hourly consumption (min. - max.)

0,6 - 1,6 kg/h \*\*

Dimensions (WxHxD)

506 x 887 x 560 mm \*\*

Net weight

84 kg \*\*

Smoke outlet diameter (Ø)

80 mm R \*\*

Total tank capacity

~11 kg / ~18 l \*\*

Electric consumption (min. - max.)

30 - 60 W \*\*

## TECHNOLOGY



Glass cleaning system



Removable brazier for easy cleaning



Self-adjusting smoke extractor (encoder)



Primary and secondary air self-balancing



External ambient thermostat connection



Airtightness test at 50 pa (100% products)



Flue safety pressure switch



Programmable thermostat



Automatic reignition after blackout



Ambient temperature thermostat



Clean combustion



Cast iron doors

## FINISHES

Painted steel two-tone cladding



White



Bronze



Black

## STANDARD EQUIPMENT



### RADIO REMOTE CONTROL

Radio remote control with "handheld device", with thermostat function



### DISPLAY WITH BUILT-IN WI-FI

("Total Control 3.0" app)

New 2022

**A+** | 8,0\*\* kW-N | 230\*\* m<sup>3</sup>

## CHARACTERISTICS



- Removable brazier for easy cleaning
- Removable ash compartment
- Room temperature control with AUTOMATIC function
- Home automation integration with "Alexa"
- Easy Setup
- Easy Control
- Self Control

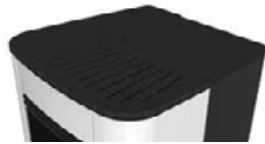

Thick top

## ECODESIGN\*\*



Download technical data sheet



SCAN ME

## TECHNICAL DATA

**Nominal power (min. - max.)**

2,5 - 8,0 kW-N \*\*

**Efficiency (min. - max.)**

94,7 - 91,5 % \*\*

**Hourly consumption (min. - max.)**

0,5 - 1,8 kg/h \*\*

**Dimensions (WxHxD)**

507 x 1007 x 558 mm \*\*

**Net weight**

93 kg \*\*

**Smoke outlet diameter (Ø)**

80 mm R \*\*

**Total tank capacity**

~15 kg / ~24 ℓ \*\*

**Electric consumption (min. - max.)**

25 - 60 W \*\*

## TECHNOLOGY



Glass cleaning system



Removable brazier for easy cleaning



Self-adjusting smoke extractor (encoder)



Tank safety thermostat



Primary and secondary air self-balancing



External ambient thermostat connection



Airtightness test at 50 pa (100% products)



Flue safety pressure switch



Programmable thermostat



Automatic reignition after blackout



Ambient temperature thermostat



Clean combustion



Cast iron doors

## FINISHES

Painted steel cladding



White



Black

## STANDARD EQUIPMENT



### RADIO REMOTE CONTROL

Radio remote control with "handheld device", with thermostat function



### DISPLAY WITH BUILT-IN WI-FI

("Total Control 3.0" app)



# ANGELA EVO

Ventilated and **hermetic** pellet stove

Evolution  
*Life*

**A+** | 8,0 kW-N | 230 m<sup>3</sup>

## CHARACTERISTICS



- Output smoke outlet possibilities: rear
- Emergency module
- Extractable burn pot for easy cleaning

## ECODESIGN



Download  
Technical Sheet



SCAN ME

## TECHNICAL DATA

**Nominal power (min-max)**  
2,5 - 8,0 kW-N

**Efficiency (min-max)**  
94,7 - 91,5 %

**Hourly consumption (min-max)**  
0,5 - 1,8 kg/h

**Dimensions (LxHxD)**  
490 x 1007 x 528 mm

**Net weight**  
93 kg

**Fumes flue diameter (Ø)**  
80 mm B

**Tank total capacity**  
~15 kg / ~24 ℓ

**Power absorption (min-max)**  
25 - 60 W

## TECHNOLOGY

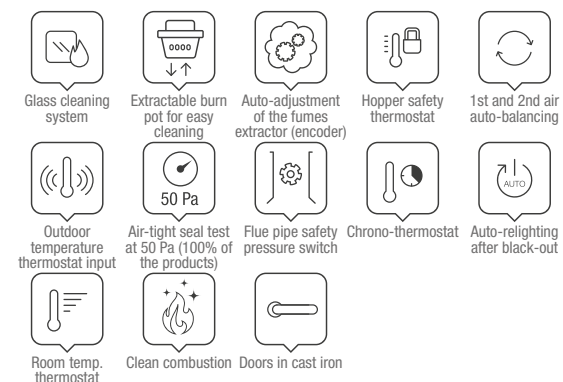

## COLOUR CHOICES

High temperature painted steel covering and majolica top cover



Bordeaux

Black

White

## STANDARD EQUIPMENT



### REMOTE CONTROL

Control with radio-controlled "hand-held" device, with thermostat function

# PAMELA STEEL

Ventilated and **hermetic** pellet stove

Evolution  
*Life*

**A+** | 8,0 kW-N | 230 m<sup>3</sup>

## CHARACTERISTICS

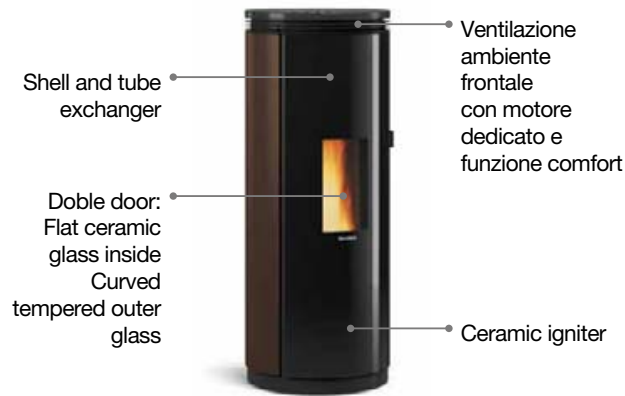

- Output smoke outlet possibilities: rear aligned
- Hearth, door fire and brazier in cast iron
- Emergency module
- Extractable burn pot for easy cleaning
- Extractable Ash compartment

## ECODESIGN



Download  
Technical Sheet



SCAN ME

## TECHNICAL DATA

**Nominal power (min-max)**  
2,5 - 8,0 kW-N

**Efficiency (min-max)**  
92,6 - 91,2 %

**Hourly consumption (min-max)**  
0,6 - 1,8 kg/h

**Dimensions (LxHxD)**  
470 x 1197 x 470 mm

**Net weight**  
130 kg

**Fumes flue diameter (Ø)**  
80 mm B

**Tank total capacity**  
~15 kg / ~24 l

**Power absorption (min-max)**  
28 - 67 W

## TECHNOLOGY

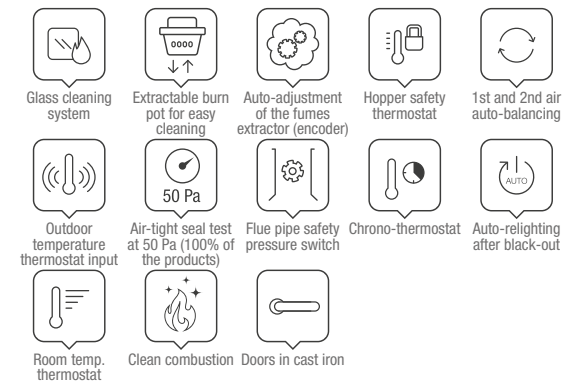

## COLOUR CHOICES

High temperature painted steel covering



Bronze

Tortora

## STANDARD EQUIPMENT



**REMOTE CONTROL**  
Control with radio-controlled "hand-held" device, with thermostat function

## OPTIONAL



**Kit Glass Night View ROBOX®**

# PAMELA CRYSTAL - BLSC

Airtight, ventilated pellet stove

Evolution  
*Life*

New 2022

**A+** | 8,0 kW-N | 230 m<sup>3</sup>

Download  
technical data sheet



SCAN ME

## CHARACTERISTICS



- Smoke discharge outlet option: rear on axis
- Cast iron door, hearth and brazier
- Emergency module
- Removable brazier for easy cleaning
- Removable ash compartment



## ECODESIGN



## TECHNICAL DATA

**Nominal power (min. - max.)**

2,5 - 8,0 kW-N

**Efficiency (min. - max.)**

92,6 - 91,2 %

**Hourly consumption (min. - max.)**

0,6 - 1,8 kg/h

**Dimensions (WxHxD)**

470 x 1197 x 470 mm

**Net weight**

140 kg

**Smoke outlet diameter (Ø)**

80 mm R

**Total tank capacity**

~15 kg / ~24 ℓ

**Electric consumption (min. - max.)**

28 - 67 W

## TECHNOLOGY



Glass cleaning system



Removable brazier for easy cleaning



Self-adjusting smoke extractor (encoder)



Tank safety thermostat



Primary and secondary air self-balancing



External ambient thermostat connection



Airtightness test at 50 pa (100% products)



Flue safety pressure switch



Programmable thermostat



Automatic reignition after blackout



Ambient temperature thermostat



Clean combustion



Cast iron doors

## FINISHES

Tempered glass cladding



Crystal BLSC

## STANDARD EQUIPMENT



### RADIO REMOTE CONTROL

Radio remote control with "handheld device", with thermostat function

**A+** | 9,0 kW-N | 258 m<sup>3</sup>

## CHARACTERISTICS



- Shell and tube exchanger
- T tube integrated in the product, inspectable from the rear
- Hearth, door fire and brazier in cast iron
- Emergency module
- Extractable burn pot for easy cleaning
- Extractable ash drawer

## ECODESIGN



Download  
Technical Sheet



SCAN ME

## TECHNICAL DATA

**Nominal power (min-max)**  
3,8 - 9,0 kW-N

**Efficiency (min-max)**  
92,2 - 92,7 %

**Hourly consumption (min-max)**  
0,9 - 2,0 kg/h

**Dimensions (LxHxD)**  
550 x 1200 x 573 mm

**Net weight**  
141 kg  
PT 167 kg

**Fumes flue diameter (Ø)**  
Debby 80 mm B/T

**Tank total capacity**  
~18 kg / ~29 ℓ

**Power absorption (min-max)**  
24 - 62 W

## TECHNOLOGY

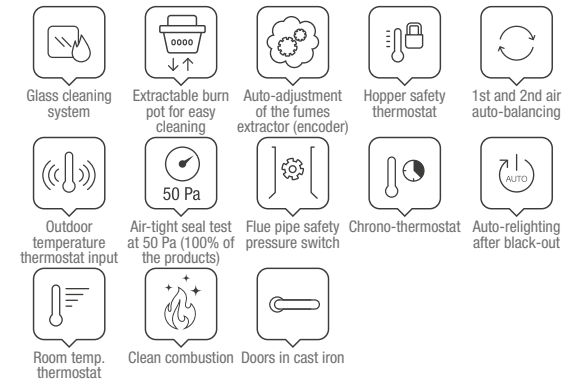

## COLOUR CHOICES

High temperature painted steel covering and majolica top cover or natural stone



White

Black

Natural stone (PT)

## STANDARD EQUIPMENT



**REMOTE CONTROL**  
Control with radio-controlled "hand-held" device, with thermostat function

## OPTIONAL



**Kit Glass Night View ROBOX®**

# MIETTA EVO

Ventilated and **hermetic** pellet stove

Evolution  
*Life*

**A+** | 9,0 kW-N | 258 m<sup>3</sup>

## CHARACTERISTICS



- Shell and tube exchanger
- Output smoke outlet possibilities: rear
- Combustion chamber probe
- Hearth, door fire and brazier in cast iron
- Emergency module
- Extractable ash drawer
- Possibility to select the power even into the individual slot of chrono

## ECODESIGN



Download  
Technical Sheet



SCAN ME

## TECHNICAL DATA

### Nominal power (min-max)

3,4 - 9,0 kW-N

### Efficiency (min-max)

93,9 - 93,1 %

### Hourly consumption (min-max)

0,8 - 2,0 kg/h

### Dimensions (LxHxD)

496 x 1073 x 579 mm

### Net weight

157 kg

### Fumes flue diameter (Ø)

80 mm B

### Tank total capacity

~20 kg / ~32 ℓ

### Power absorption (min-max)

26 - 43 W

## TECHNOLOGY



Glass cleaning system



Auto-adjustment of the fumes extractor (encoder)



Hopper safety thermostat



1st and 2nd air auto-balancing



Outdoor temperature thermostat input



Air-tight seal test at 50 Pa (100% of the products)



Flue pipe safety pressure switch



Chrono-thermostat



Auto-relighting after black-out



Room temp. thermostat



Clean combustion



Doors in cast iron

## COLOUR CHOICES

High temperature painted steel covering and majolica top cover



Bordeaux



White

## STANDARD EQUIPMENT



### REMOTE CONTROL

Control with radio-controlled "hand-held" device, with thermostat function

# KATIA 9

Airtight, ventilated pellet stove

Evolution  
Life

New 2022

A+ | 9,0\*\* kW-N | 258\*\* m<sup>3</sup>

## CHARACTERISTICS



- Shell and tube heat exchanger
- Cast iron door, hearth and brazier
- Double glass door
- Combustion chamber probe
- Room temperature control with AUTOMATIC function
- Home automation integration with "Alexa"
- Easy Setup
- Easy Control
- Self Control



Curved ceramic glass

## ECODESIGN\*\*



Download  
technical data sheet



SCAN ME

## TECHNICAL DATA

Nominal power (min. - max.)

3,4 - 9,0 kW-N \*\*

Efficiency (min. - max.)

93,9 - 93,1 % \*\*

Hourly consumption (min. - max.)

0,8 - 2,0 kg/h \*\*

Dimensions (WxHxD)

515 x 1082 x 572\* mm \*\*

Net weight

160 kg \*\*

Smoke outlet diameter (Ø)

80 mm R \*\*

Total tank capacity

~20 kg / ~32 ℓ \*\*

Electric consumption (min. - max.)

26 - 43 W \*\*

## TECHNOLOGY



## FINISHES

Painted steel cladding



White

Bronze

Dove grey

## STANDARD EQUIPMENT



### RADIO REMOTE CONTROL

Radio remote control with "handheld device", with thermostat function

### DISPLAY WITH BUILT-IN WI-FI

("Total Control 3.0" app)

# KATIA 11

Airtight, ventilated pellet stove

Evolution  
*Life*

New 2022

**A+** | 11,0\*\* kW-N | 315\*\* m<sup>3</sup>

Download  
technical data sheet



SCAN ME

## CHARACTERISTICS



- Shell and tube heat exchanger
- Cast iron door, hearth and brazier
- Double glass door
- Combustion chamber probe
- Room temperature control with AUTOMATIC function
- Home automation integration with "Alexa"
- Easy Setup
- Easy Control
- Self Control



Curved ceramic glass

## ECODESIGN\*\*



## TECHNICAL DATA

Nominal power (min. - max.)

3,4 - 11,0 kW-N \*\*

Efficiency (min. - max.)

93,9 - 91,4 % \*\*

Hourly consumption (min. - max.)

0,8 - 2,5 kg/h \*\*

Dimensions (WxHxD)

515 x 1082 x 572\* mm \*\*

Net weight

160 kg \*\*

Smoke outlet diameter (Ø)

80 mm R \*\*

Total tank capacity

~20 kg / ~32 ℓ \*\*

Electric consumption (min. - max.)

25 - 45 W \*\*

## TECHNOLOGY



Glass cleaning system



Self-adjusting smoke extractor (encoder)



Tank safety thermostat



Primary and secondary air self-balancing



External ambient thermostat connection



Airtightness test at 50 Pa (100% products)



Flue safety pressure switch



Programmable thermostat



Automatic reignition after blackout



Ambient temperature thermostat



Clean combustion



Cast iron doors

## FINISHES

Painted steel cladding



White



Bronze



Dove grey

## STANDARD EQUIPMENT



### RADIO REMOTE CONTROL

Radio remote control with "handheld device", with thermostat function

### DISPLAY WITH BUILT-IN WI-FI

("Total Control 3.0" app)

\*\* Technical data may be subject to changes, approval pending

**A+** | 11,0 kW-N | 315 m<sup>3</sup>

## CHARACTERISTICS



- Output smoke outlet possibilities: rear
- Shell and tube exchanger
- Combustion chamber probe
- Hearth, door fire and brazier in cast iron
- Emergency module
- Single door with double glass ceramic
- Extractable burn pot for easy cleaning
- Extractable ash drawer
- Removable handle with storage compartment

## ECODESIGN



Download  
Technical Sheet



SCAN ME

## TECHNICAL DATA

**Nominal power (min-max)**  
3,4 - 11,0 kW-N

**Efficiency (min-max)**  
93,9 - 91,4 %

**Hourly consumption (min-max)**  
0,8 - 2,5 kg/h

**Dimensions (LxHxD)**  
480 x 1140 x 560 mm

**Net weight**  
173 kg

**Fumes flue diameter (Ø)**  
80 mm B

**Tank total capacity**  
~22 kg / ~35 l

**Power absorption (min-max)**  
25 - 45 W

## TECHNOLOGY

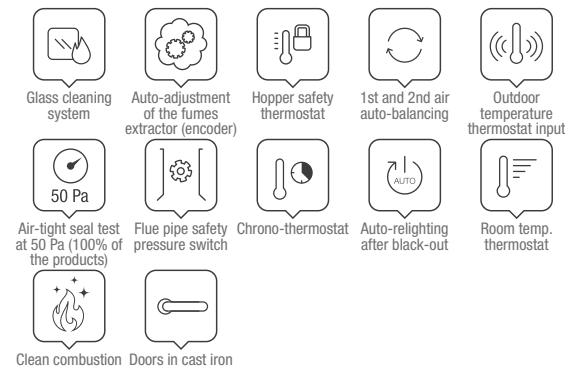

## COLOUR CHOICES

Painted steel covered, top and bottom in majolica



White

Bright tortora

## STANDARD EQUIPMENT



**REMOTE CONTROL**  
Control with radio-controlled "hand-held" device, with thermostat function



New 2022

**A+** | 12,0\*\* kW-N | 344\*\* m<sup>3</sup>

Download  
technical data sheet

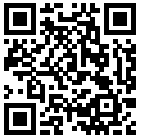

SCAN ME

## CHARACTERISTICS



- Cast iron door, hearth and brazier
- Extractable ash drawer
- Brushless gear motor for pellet loading
- Combustion chamber probe
- FPC – An innovative adaptive system for regulating and maintaining air combustion constant over time
- Home automation integration with "Alexa" (Amazon). N.B. only with "Grey label" WiFi module – optional – and using the App Total Control 3.0. Service and "Alexa" device (Amazon) not included
- Easy Setup
- Easy Control
- Self Control

## ECODESIGN\*\*



## TECHNICAL DATA

Nominal power (min. - max.)

3,6 - 12,0 kW-N \*\*

Efficiency (min. - max.)

92,5 - 91,0 % \*\*

Hourly consumption (min. - max.)

0,8 - 2,7 kg/h \*\*

Dimensions (WxHxD)

576 x 1174 x 606 mm \*\*

Net weight

190 kg \*\*

Smoke outlet diameter (Ø)

80 mm R \*\*

Total tank capacity

~30 kg / ~46 ℓ \*\*

Electric consumption (min. - max.)

50 - 90 W \*\*

## TECHNOLOGY

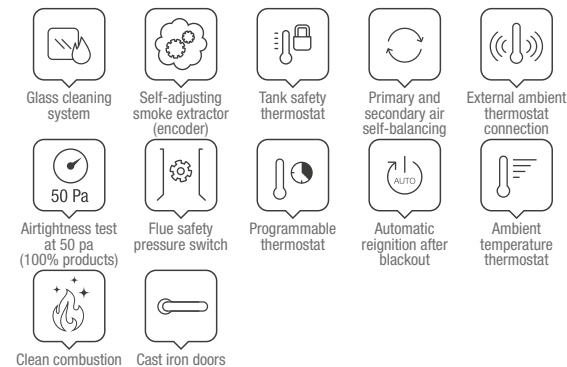

## FINISHES

Painted steel cladding



White

Bronze

Dove grey

## STANDARD EQUIPMENT



**REMOTE CONTROL**

Backlit IR Touch remote control



**BLACK LCD**

# NORIS LUX

Airtight, ventilated pellet stove

Evolution  
*Life*

New 2022

**A+** | 12,0\*\* kW-N | 344\*\* m<sup>3</sup>

Download  
technical data sheet



SCAN ME

## CHARACTERISTICS



- Cast iron door, hearth and brazier
- Extractable ash drawer
- Brushless gear motor for pellet loading
- Combustion chamber probe
- FPC – An innovative adaptive system for regulating and maintaining air combustion constant over time
- Home automation integration with "Alexa" (Amazon). N.B. only with "Grey label" WiFi module – optional – and using the App Total Control 3.0. Service and "Alexa" device (Amazon) not included
- Easy Setup
- Easy Control
- Self Control

## ECODESIGN\*\*



## TECHNICAL DATA

Nominal power (min. - max.)

3,6 - 12,0 kW-N \*\*

Efficiency (min. - max.)

92,5 - 91,0 % \*\*

Hourly consumption (min. - max.)

0,8 - 2,7 kg/h \*\*

Dimensions (WxHxD)

576 x 1174 x 606 mm \*\*

Net weight

196 kg \*\*

Smoke outlet diameter (Ø)

80 mm R \*\*

Total tank capacity

~30 kg / ~46 ℓ \*\*

Electric consumption (min. - max.)

50 - 90 W \*\*

## TECHNOLOGY



Glass cleaning system



Self-adjusting smoke extractor (encoder)



Tank safety thermostat



Primary and secondary air self-balancing



External ambient thermostat connection



Airtightness test at 50 pa (100% products)



Flue safety pressure switch



Programmable thermostat



Automatic reignition after blackout



Ambient temperature thermostat



Clean combustion



Cast iron doors

## FINISHES

Majolica and painted steel cladding



White



Dove grey

## STANDARD EQUIPMENT



**REMOTE CONTROL**

Backlit IR Touch remote control



**BLACK LCD**

TELL PEOPLE  
ABOUT  
THE  
NEW  
TECHNOLOGY  
TO  
SAVE  
THE  
WORLD

Evolution  
*Life*

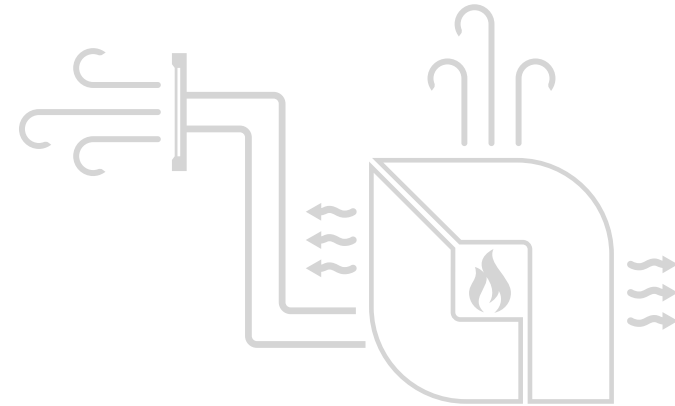

The product range with one or more motors dedicated to thermostable duct heating.

UP TO 8 METRES

PER DUCT



#### AIR-TIGHT STOVE

**SAFE:** Technology and innovation at the service of your safety.



#### HOME CONTROL SOLUTION

**INNOVATIVE:** Always in contact with your stove, even when you are away from home

# ANGELA PLUS EVO

Hermetic pellet stove with ducting system

Evolution  
*Life*

**A+** | 8,0 kW-N | 230 m<sup>3</sup>

## CHARACTERISTICS



- Output smoke outlet possibilities: rear
- Ducting system output possibilities (Ø80 mm): rear
- Emergency module
- Extractable burn pot for easy cleaning
- Extractable Ash compartment

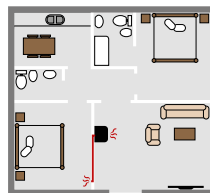

UP TO 8 METRES OF DUCTS through one back output Ø80 (excludable)

## ECODESIGN



Download  
Technical Sheet



SCAN ME

## TECHNICAL DATA

**Nominal power (min-max)**  
2,5 - 8,0 kW-N

**Efficiency (min-max)**  
94,9 - 91,9 %

**Hourly consumption (min-max)**  
0,5 - 1,8 kg/h

**Dimensions (LxHxD)**  
490 x 1007 x 528 mm

**Net weight**  
98 kg

**Fumes flue diameter (Ø)**  
80 mm B

**Tank total capacity**  
~15 kg / ~24 ℓ

**Power absorption (min-max)**  
50 - 80 W

## TECHNOLOGY



Glass cleaning system



Extractable burn pot for easy cleaning



Auto-adjustment of the fumes extractor (encoder)



Hopper safety thermostat



1st and 2nd air auto-balancing



Outdoor temperature thermostat input



Air-tight seal test at 50 Pa (100% of the products)



Flue pipe safety pressure switch



Chrono-thermostat



Auto-relighting after black-out



Room temp. thermostat



Clean combustion



Doors in cast iron

## COLOUR CHOICES

High temperature painted steel covering and majolica top cover



White



Bordeaux



Black

## STANDARD EQUIPMENT



### REMOTE CONTROL

Control with radio-controlled "hand-held" device, with thermostat function

# ILARY PLUS

Airtight, **ducted** pellet stove

Evolution  
*Life*

New 2022

**A+** | 8,0\*\* kW-N | 230\*\* m<sup>3</sup>

## CHARACTERISTICS



- Removable brazier for easy cleaning
- Removable ash compartment
- Shell and tube heat exchanger
- Ducting with dedicated motor up to 8 metres, thermostatically controlled and removable + AIR ZONE CONTROL
- Room temperature control with AUTOMATIC function
- Home automation integration with "Alexa"
- Easy Setup
- Easy Control
- Self Control

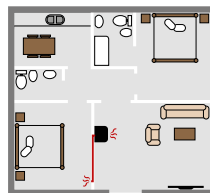

UP TO 8 METRES OF DUCTS  
through one back output Ø80  
(excludable)

## ECODESIGN\*\*

Download  
technical data sheet



SCAN ME



## TECHNICAL DATA

Nominal power (min. - max.)

2,5 - 8,0 kW-N \*\*

Efficiency (min. - max.)

94,9 - 91,9 % \*\*

Hourly consumption (min. - max.)

0,5 - 1,8 kg/h \*\*

Dimensions (WxHxD)

507 x 1007 x 558 mm \*\*

Net weight

93 kg \*\*

Smoke outlet diameter (Ø)

80 mm R \*\*

Total tank capacity

~15 kg / ~24 ℓ \*\*

Electric consumption (min. - max.)

50 - 80 W \*\*

## TECHNOLOGY



Glass cleaning system



Removable brazier for easy cleaning



Self-adjusting smoke extractor (encoder)



Tank safety thermostat



Primary and secondary air self-balancing



External ambient thermostat connection



Airtightness test at 50 pa (100% products)



Flue safety pressure switch



Programmable thermostat



Automatic reignition after blackout



Ambient temperature thermostat



Clean combustion



Cast iron doors

## FINISHES

Painted steel cladding



White



Black

## STANDARD EQUIPMENT



### RADIO REMOTE CONTROL

Radio remote control with "handheld device", with thermostat function



### DISPLAY WITH BUILT-IN WI-FI

("Total Control 3.0" app)

\*\* Technical data may be subject to changes, approval pending

# GABRIELLA PLUS

Tight and **hermetic** pellet stove with ducting system

Evolution  
*Life*

**A+** | 8,0 kW-N | 230 m<sup>3</sup>

## CHARACTERISTICS

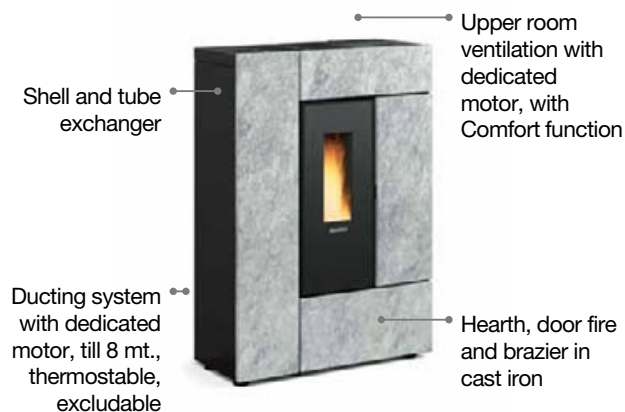

- Output smoke outlet possibilities: upper-backside, upper
- Extractable burn pot for easy cleaning
- Extractable Ash compartment

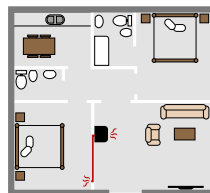

UP TO 8 METRES OF DUCTS through one back or left side output Ø80 (excludable)

## ECODESIGN



Download  
Technical Sheet



SCAN ME

## TECHNICAL DATA

**Nominal power (min-max)**  
3,5 - 8,0 kW-N

**Efficiency (min-max)**  
94,1 - 94,0 %

**Hourly consumption (min-max)**  
0,8 - 1,8 kg/h

**Dimensions (LxHxD)**  
750 x 1077 x 350 mm

**Net weight**  
132 kg  
PT 160 kg

**Fumes flue diameter (Ø)**  
80 mm B/T

**Tank total capacity**  
~15 kg / ~24 ℓ

**Power absorption (min-max)**  
50 - 90 W

## TECHNOLOGY

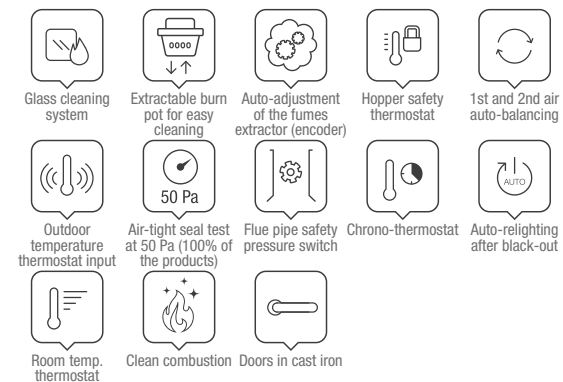

## COLOUR CHOICES

High temperature painted steel covering or natural stone



White

Bronze

Natural stone (PT)

## STANDARD EQUIPMENT



**REMOTE CONTROL**  
Backlit IR touch remote control



**BLACK LCD**

# SHARON PLUS

Tight and **hermetic** pellet stove with ducting system

Evolution  
*Life*

**A+** | 10,0 kW-N | 287 m<sup>3</sup>

## CHARACTERISTICS



- Extractable burn pot for easy cleaning
- Output smoke outlet possibilities: rear, upper
- Ducting system output possibilities (Ø80 mm): rear
- Radiant surface heat exchanger
- Double door: Glass ceramic external door
- Wide fire vision
- Reduced depth (slim)
- Emergency module
- Ash compartment
- Door fire and brazier in cast iron
- With the AUTOMATIC function activated, the stove manages the power output so that the room temperature set by the user remains constant. This minimises power fluctuations to the benefit of thermal and acoustic comfort
- With AIR ZONE CONTROL (AZC) the speed of rotation of the ducting fan is managed with the aim of maximising the transmission of thermal power in the ducted environment

## ECODESIGN



Download  
Technical Sheet



SCAN ME

## TECHNICAL DATA

**Nominal power (min-max)**  
3,5 - 10,0 kW-N

**Efficiency (min-max)**  
91,7 - 91,0 %

**Hourly consumption (min-max)**  
0,8 - 2,3 kg/h

**Dimensions (LxHxD)**  
900 x 1150 x 290 mm

**Net weight**  
155 kg - PT 167 kg

**Fumes flue diameter (Ø)**  
80mm B/T

**Tank total capacity**  
~21 kg / ~33 ℓ

**Power absorption (min-max)**  
30 - 50 W

## TECHNOLOGY

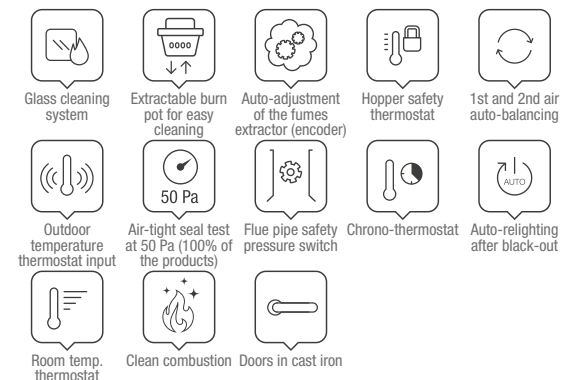

## COLOUR CHOICES

Glass or natural stone covered



Crystal

Natural stone (PT)



## STANDARD EQUIPMENT

**REMOTE CONTROL**  
Control with radio-controlled "hand-held" device, with thermostat function

# SHARON PLUS STEEL

Airtight, **ducted**, slim pellet stove

Evolution  
*Life*

New 2022

**A+** | 10,0\*\* kW-N | 287\*\* m<sup>3</sup>

## CHARACTERISTICS

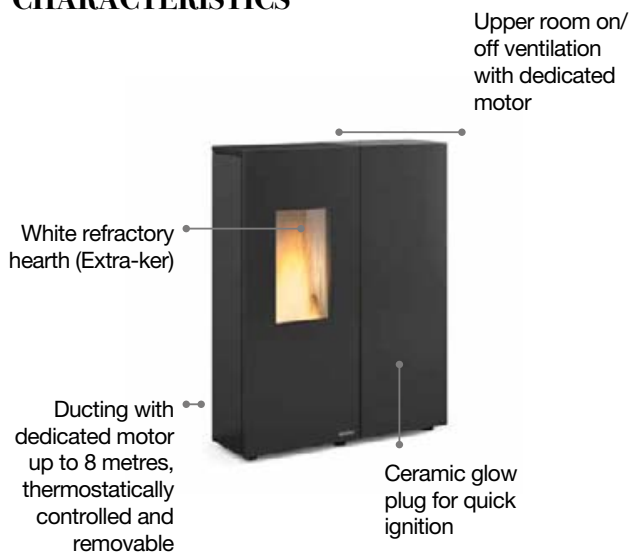

- Removable brazier for easy cleaning
- Smoke discharge outlet option: rear, upper
- Ducting outlet options (Ø80 mm): rear
- Radiant surface heat exchanger
- Double door: outer door with ceramic glass
- Wide view of the flame
- Reduced depth
- Emergency module
- Ash compartment
- Cast iron door and brazier
- With the AUTOMATIC function activated, the stove manages the power output so that the room temperature set by the user remains constant. This minimises power fluctuations to the benefit of thermal and acoustic comfort
- With AIR ZONE CONTROL (AZC) the speed of rotation of the ducting fan is managed with the aim of maximising the transmission of thermal power in the ducted environment

## ECODESIGN\*\*



Download  
technical data sheet



SCAN ME

## TECHNICAL DATA

**Nominal power (min. - max.)**  
3,5 - 10,0 kW-N \*\*

**Efficiency (min. - max.)**  
91,7 - 91,0 % \*\*

**Hourly consumption (min. - max.)**  
0,8 - 2,3 kg/h \*\*

**Dimensions (WxHxD)**  
900 x 1150 x 290 mm \*\*

**Net weight**  
155 kg \*\*

**Smoke outlet diameter (Ø)**  
80 mm R/U \*\*

**Total tank capacity**  
~21 kg / ~33 ℓ \*\*

**Electric consumption (min. - max.)**  
30 - 50 W \*\*

## TECHNOLOGY

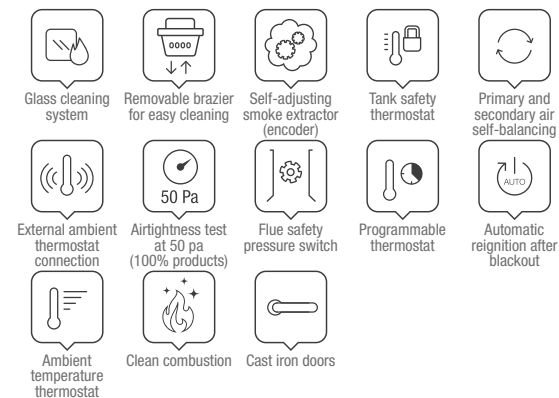

## FINISHES

Painted steel cladding



Black

## STANDARD EQUIPMENT

**RADIO REMOTE CONTROL**  
Radio remote control with "handheld device", with thermostat function



**DISPLAY WITH BUILT-IN WI-FI**  
("Total Control 2.0" app)



# NORIS PLUS

Airtight, double ducted pellet stove

Evolution  
*Life*

New 2022

**A+** | 12,0\*\* kW-N | 344\*\* m<sup>3</sup>

Download  
technical data sheet



SCAN ME

## CHARACTERISTICS



- New “5-star” brazier
- Cast iron door, hearth and brazier
- Extractable ash drawer
- Brushless gear motor for pellet loading
- Combustion chamber probe
- AIR ZONE CONTROL function for ducting
- FPC – An innovative adaptive system for regulating and maintaining air combustion constant over time
- Home automation integration with “Alexa” (Amazon).N.B. only with “Grey label” WiFi module – optional – and using the App Total Control 3.0. Service and “Alexa” device (Amazon) not included
- Easy Setup
- Easy Control
- Self Control



UP TO 16 METRES (8m for 2 outputs) OF DUCTS

## ECODESIGN\*\*



## TECHNICAL DATA

Nominal power (min. - max.)

3,6 - 12,0 kW-N \*\*

Efficiency (min. - max.)

93,0 - 91,5 % \*\*

Hourly consumption (min. - max.)

0,8 - 2,7 kg/h \*\*

Dimensions (WxHxD)

576 x 1174 x 606 mm \*\*

Net weight

200 kg \*\*

Smoke outlet diameter (Ø)

80 mm R \*\*

Total tank capacity

~30 kg / ~46 ℓ \*\*

Electric consumption (min. - max.)

50 - 96 W \*\*

## TECHNOLOGY



Glass cleaning system



Self-adjusting smoke extractor (encoder)



Tank safety thermostat



Primary and secondary air self-balancing



External ambient thermostat connection



Airtightness test at 50 pa (100% products)



Flue safety pressure switch



Programmable thermostat



Automatic reignition after blackout



Ambient temperature thermostat



Clean combustion



Cast iron doors

## FINISHES

Painted steel cladding



White



Bronze



Dove grey

## STANDARD EQUIPMENT



**REMOTE CONTROL**

Backlit IR Touch remote control



**BLACK LCD**

# NORIS PLUS LUX

Airtight, double ducted pellet stove

Evolution  
*Life*

New 2022

**A+** | 12,0\*\* kW-N | 344\*\* m<sup>3</sup>

Download  
technical data sheet



SCAN ME

## CHARACTERISTICS

Double ducting with two dedicated motors up to 8 metres, thermostatically controlled and removable + AIR ZONE CONTROL

Ceramic glow plug for quick ignition



Ventilation and ducting with PRO AIR SET UP

Self-cleaning brazier with Brushless motor

- New "5-star" brazier
- Cast iron door, hearth and brazier
- Extractable ash drawer
- Brushless gear motor for pellet loading
- Combustion chamber probe
- AIR ZONE CONTROL function for ducting
- FPC – An innovative adaptive system for regulating and maintaining air combustion constant over time
- Home automation integration with "Alexa" (Amazon).N.B. only with "Grey label" WiFi module – optional – and using the App Total Control 3.0. Service and "Alexa" device (Amazon) not included
- Easy Setup
- Easy Control
- Self Control



UP TO 16 METRES (8m for 2 outputs) OF DUCTS

## ECODESIGN\*\*



## TECHNICAL DATA

Nominal power (min. - max.)  
3,6 - 12,0 kW-N \*\*

Efficiency (min. - max.)  
93,0 - 91,5 % \*\*

Hourly consumption (min. - max.)  
0,8 - 2,7 kg/h \*\*

Dimensions (WxHxD)  
576 x 1174 x 606 mm \*\*

Net weight  
206 kg \*\*

Smoke outlet diameter (Ø)  
80 mm R \*\*

Total tank capacity  
~30 kg / ~46 ℓ \*\*

Electric consumption (min. - max.)  
50 - 96 W \*\*

## TECHNOLOGY



Glass cleaning system



Self-adjusting smoke extractor (encoder)



Tank safety thermostat



Primary and secondary air self-balancing



External ambient thermostat connection



Airtightness test at 50 pa (100% products)



Flue safety pressure switch



Programmable thermostat



Automatic reignition after blackout



Ambient temperature thermostat



Clean combustion



Cast iron doors

## FINISHES

Majolica and painted steel cladding



White



Dove grey

## STANDARD EQUIPMENT



**REMOTE CONTROL**  
Backlit IR Touch remote control



**BLACK LCD**

# TERRY PLUS

Hermetic pellet stove with ducting system and two different outlets

Evolution  
*Life*

**A+** | 12,1 kW-N | 347 m<sup>3</sup>

## CHARACTERISTICS



- Output smoke outlet possibilities: rear
- Ducting system output possibilities (Ø80 mm): rear
- Front room ventilation with dedicated motor, with Comfort function
- Extractable hearth (only by authorized assistance)
- Hearth, door fire and brazier in cast iron
- Ergonomic handle
- Combustion chamber probe
- Shell and tube exchanger (manual cleaning)
- Emergency module
- Extractable ash drawer



UP TO 16 METRES (8m for 2 outputs) OF DUCTS with 3 independent ventilators that can be managed with 4 time ranges

## ECODESIGN



Download  
Technical Sheet



SCAN ME

## TECHNICAL DATA

**Nominal power (min-max)**  
3,5 - 12,1 kW-N

**Efficiency (min-max)**  
92,0 - 94,0 %

**Hourly consumption (min-max)**  
0,8 - 2,7 kg/h

**Dimensions (LxHxD)**  
569 x 1151 x 598 mm

**Net weight**  
206 kg

**Fumes flue diameter (Ø)**  
80 mm B

**Tank total capacity**  
~29 kg / ~46 l

**Power absorption (min-max)**  
50 - 96 W

## TECHNOLOGY

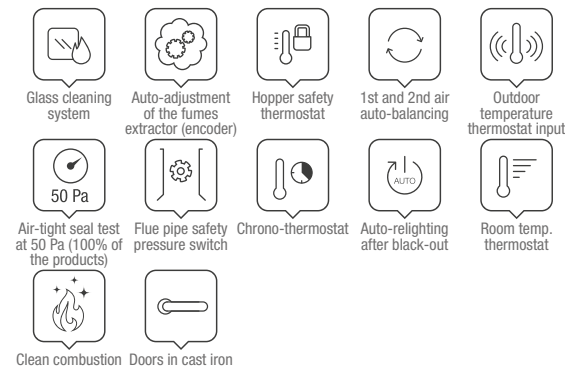

## COLOUR CHOICES

External facing in majolica



Bordeaux

White

## STANDARD EQUIPMENT



**REMOTE CONTROL**  
Control with radio-controlled "hand-held" device, with thermostat function

➤ **THE LATEST GENERATION IGNITION SYSTEM**  
**FAST:** For immediate warmth in your home, always and everywhere

🔊 **EXCLUDABLE FORCED VENTILATION**  
**SILENT:** silence, without sacrificing efficiency

⚙️ **PWM PUMP AUTOMATICALLY CONTROLLED BY THE ELECTRONIC BOARD**  
**SIMPLE:** Relax, the performance of your system is self-adjusting

≡ **NEW ELECTRONICS FOR CONNECTING TO THE SYSTEM EXPANSION CARD**  
**FLEXIBLE:** Maximum flexibility in the management of comfort in the rooms

📱 **HOME CONTROL SOLUTION**  
**INNOVATIVE:** Always in contact with your stove, even when you are away from home

🔔 **SELF-CLEANING BRAZIER**  
**CONVENIENT:** your stove cleans itself

🔥 **OPTIMISED COMBUSTION**  
**EFFICIENT:** Reduces the waiting time for relighting, ensuring optimal combustion

Silent and powerful,  
they distribute the heat  
rapidly and uniformly  
throughout the home.



Evolution  
*line*

P  
E  
L  
L  
E  
T  
H  
E  
A  
T  
I  
G  
N  
I  
T  
I  
O  
N  
S  
T  
O  
V  
E  
S

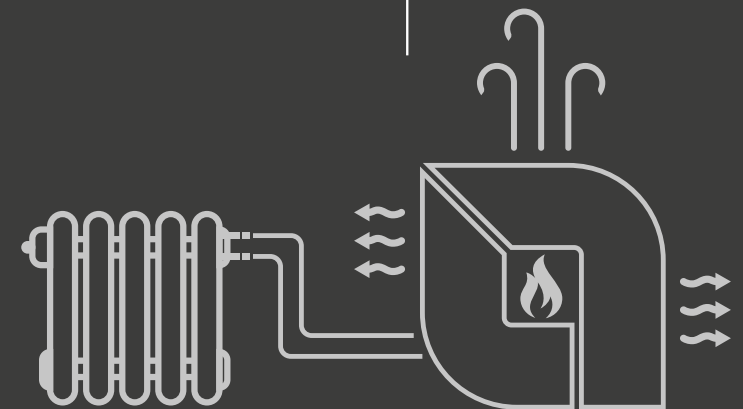

# ROSANNA IDRO

Hermetic and ventilated pellet thermo-stove

Evolution  
*Life*

**A<sup>+</sup>** | 14,2 kW-N | 11,0 kW-H<sub>2</sub>O | 407 m<sup>3</sup>

## CHARACTERISTICS



- Pressure transducer and display pressure value indication
- Output smoke outlet possibilities: rear
- Safety valve 3 bar
- Combustion chamber in thick steel
- Air relief valve
- Ergonomic handle
- Door fire and brazier in cast iron
- Thermal and pressure safety
- Expansion tank
- Extractable ash drawer

## ECODESIGN



Download  
Technical Sheet

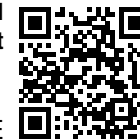

SCAN ME

## TECHNICAL DATA

**Nominal power (min-max)**  
4,1 - 14,2 kW-N

**Power given back to water (min-max)**  
2,9 - 11,0 kW-H<sub>2</sub>O

**Efficiency (min-max)**  
92,9 - 91,1 %

**Hourly consumption (min-max)**  
0,9 - 3,2 kg/h

**Dimensions (LxHxD)**  
511 x 1150 x 632 mm

**Net weight**  
163 kg

**Fumes flue diameter (Ø)**  
100 mm B

**Tank total capacity**  
~27 kg / ~43 ℓ

**Power absorption (min-max)**  
65 - 95 W

**Operating pressure (bar)**  
3 bar

## TECHNOLOGY

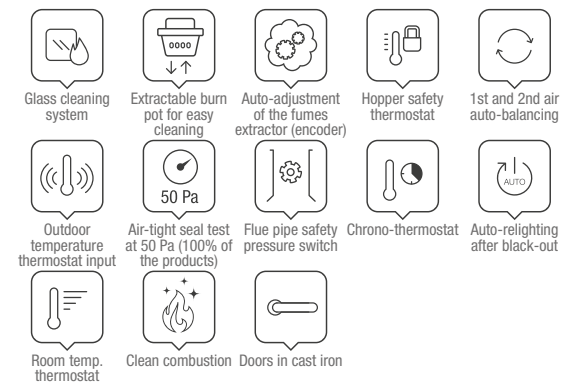

## COLOUR CHOICES

High temperature painted steel covering and majolica top cover



## STANDARD EQUIPMENT



**REMOTE CONTROL**  
Backlit IR touch remote control



**BLACK LCD**

# GUENDA IDRO

Hermetic and ventilated pellet thermo-stove

Evolution  
*Life*

**A<sup>+</sup>** | 16,2 kW-N | 14,0 kW-H<sub>2</sub>O | 465 m<sup>3</sup>

## CHARACTERISTICS



- Air relief valve
- Output smoke outlet possibilities: rear
- Wide fire vision
- Pressure transducer and display pressure value indication
- Combustion chamber in thick steel
- Ergonomic handle
- Door fire and brazier in cast iron
- Combustion chamber probe
- Shell and tube exchanger (manual cleaning)
- Thermal and pressure safety
- Expansion tank
- Safety valve 3 bar
- Extractable ash drawer

## ECODESIGN



Download  
Technical Sheet



SCAN ME

## TECHNICAL DATA

**Nominal power (min-max)**  
4,6 - 16,2 kW-N

**Power given back to water (min-max)**  
3,6 - 14,0 kW-H<sub>2</sub>O

**Efficiency (min-max)**  
90,6 - 90,9 %

**Hourly consumption (min-max)**  
1,1 - 3,7 kg/h

**Dimensions (LxHxD)**  
576 x 1157 x 621 mm

**Net weight**  
210 kg

**Fumes flue diameter (Ø)**  
100 mm B

**Tank total capacity**  
~30 kg / ~48 ℓ

**Power absorption (min-max)**  
20 - 40 W

**Operating pressure (bar)**  
3 bar

## TECHNOLOGY

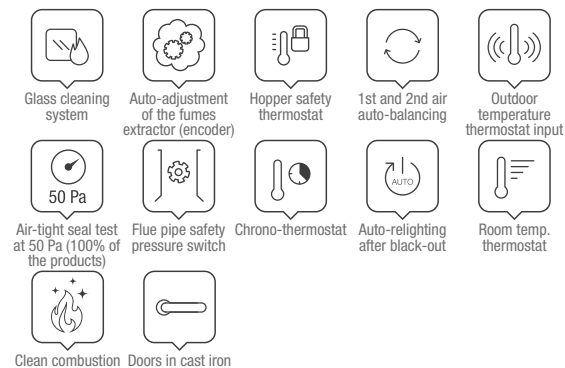

## COLOUR CHOICES

High temperature painted steel covering



## STANDARD EQUIPMENT



**REMOTE CONTROL**  
Backlit IR touch remote control



**BLACK LCD**

# FIANDRA IDRO EVO

Hermetic and ventilated pellet thermo-stove

Evolution  
*Life*

**A<sup>+</sup>** | 16,2 kW-N | 14,0 kW-H<sub>2</sub>O | 465 m<sup>3</sup>

## CHARACTERISTICS



- Output smoke outlet possibilities: rear
- Wide fire vision
- Pressure transducer and display pressure value indication
- Combustion chamber in thick steel
- Ergonomic handle
- Door fire and brazier in cast iron
- Combustion chamber probe
- Air relief valve
- Emergency module
- Shell and tube exchanger (manual cleaning)
- Thermal and pressure safety
- Expansion tank
- Safety valve 3 bar
- Extractable ash drawer

## ECODESIGN



Download  
Technical Sheet

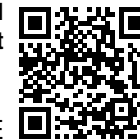

SCAN ME

## TECHNICAL DATA

**Nominal power (min-max)**  
4,6 - 16,2 kW-N

**Power given back to water (min-max)**  
3,6 - 14,0 kW-H<sub>2</sub>O

**Efficiency (min-max)**  
90,6 - 90,9 %

**Hourly consumption (min-max)**  
1,1 - 3,7 kg/h

**Dimensions (LxHxD)**  
570 x 1145 x 621 mm

**Net weight**  
226 kg

**Fumes flue diameter (Ø)**  
100 mm B

**Tank total capacity**  
~30 kg / ~48 ℓ

**Power absorption (min-max)**  
20 - 40 W

**Operating pressure (bar)**  
3,0 bar

## TECHNOLOGY



Glass cleaning system



Auto-adjustment of the fumes extractor (encoder)



Hopper safety thermostat



1st and 2nd air auto-balancing



Outdoor temperature thermostat input



Air-tight seal test at 50 Pa (100% of the products)



Flue pipe safety pressure switch



Chrono-thermostat



Auto-re-lighting after black-out



Room temp. thermostat



Clean combustion



Doors in cast iron

## COLOUR CHOICES

External facing in majolica



Panna

## STANDARD EQUIPMENT



### REMOTE CONTROL

Control with radio-controlled "hand-held" device, with thermostat function

# EVELYNE IDRO 2.0

Airtight, ventilated, slim pellet thermo-stove

Evolution  
*Life*

New 2022

**A+** | 18,0 kW-N | 14,8 kW-H<sub>2</sub>O | 517 m<sup>3</sup>

## CHARACTERISTICS

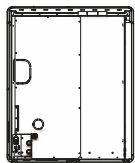
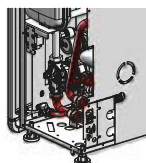
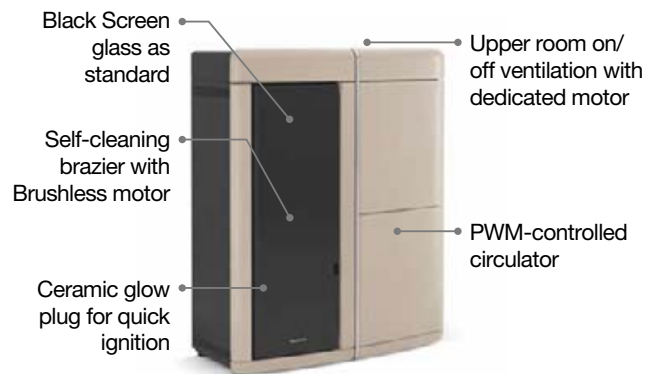

**Side plumbing attachments.**  
New location, easy to reach for connections and maintenance.

- Vent
- Smoke discharge outlet option: rear, upper, right-hand side
- Reduced depth
- Pressure transducer with display
- Thick steel combustion chamber
- Cast iron door and brazier
- Combustion chamber probe
- Double door: outer door with flat tempered glass
- Side shell and tube heat exchanger (manual cleaning)
- Emergency module
- Thermal and water pressure relief valves
- Expansion tank
- Safety valve 3 bar
- Extractable ash drawer

## ECODESIGN



Download technical data sheet



SCAN ME

## TECHNICAL DATA

**Nominal power (min. - max.)**

5,3 - 18,0 kW-N

**Water heating power (min. - max.)**

3,5 - 14,8 kW-H<sub>2</sub>O

**Efficiency (min. - max.)**

95,9 - 93,5 %

**Hourly consumption (min. - max.)**

1,1 - 4,0 kg/h

**Dimensions (WxHxD)**

878 x 1098 x 412 mm

**Net weight**

209 kg

**Smoke outlet diameter (Ø)**

100 mm R/U/RH side

**Total tank capacity**

~27 kg / ~43 ℓ

**Electric consumption (min. - max.)**

80 - 85 W

**Working pressure (bar)**

3 bar

## TECHNOLOGY



Glass cleaning system



Self-adjusting smoke extractor (encoder)



Tank safety thermostat



Primary and secondary air self-balancing



External ambient thermostat connection



Airtightness test at 50 pa (100% products)



Flue safety pressure switch



Programmable thermostat



Automatic reignition after blackout



Ambient temperature thermostat



Clean combustion



Cast iron doors

## FINISHES

Majolica cladding



Grey



White



Dove grey



## STANDARD EQUIPMENT

### RADIO REMOTE CONTROL

Radio remote control with "handheld device", with thermostat function

### DISPLAY WITH BUILT-IN WI-FI

("Total Control 2.0" app)



# ISIDORA IDRO H16

Ventilated pellet thermo-stove

Evolution  
*Life*

**A+** | 18,7 kW-N | 16,0 kW-H<sub>2</sub>O | 536 m<sup>3</sup>

## CHARACTERISTICS



- Air relief valve
- Upper room ventilation with dedicated motor, excludable
- Output smoke outlet possibilities: rear aligned
- Pressure transducer and display pressure value indication
- Combustion chamber in thick steel
- Ergonomic handle
- Door fire and brazier in cast iron
- Hermetic tank
- Combustion chamber probe
- Shell and tube exchanger (manual cleaning)
- Thermal and pressure safety
- Wide fire vision
- Expansion tank
- Safety valve 3 bar
- Extractable ash drawer

## ECODESIGN



Download  
Technical Sheet



SCAN ME

## TECHNICAL DATA

**Nominal power (min-max)**  
5,6 - 18,7 kW-N

**Power given back to water (min-max)**  
4,3 - 16,0 kW-H<sub>2</sub>O

**Efficiency (min-max)**  
91,5 - 92,4 %

**Hourly consumption (min-max)**  
1,3 - 4,2 kg/h

**Dimensions (LxHxD)**  
596 x 1165 x 708 mm

**Net weight**  
227 kg

**Fumes flue diameter (Ø)**  
100 mm B

**Tank total capacity**  
~33 kg / ~53 ℓ

**Power absorption (min-max)**  
60 - 85 W

**Operating pressure (bar)**  
3 bar

## TECHNOLOGY

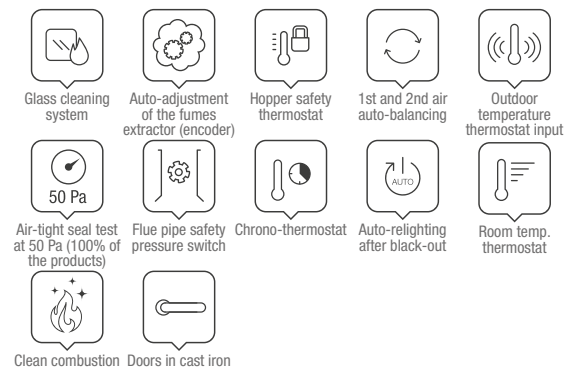

## COLOUR CHOICES

Finish in majolica and painted sheet metal



Bordeaux

White

Bright tortora

## STANDARD EQUIPMENT



### REMOTE CONTROL

Backlit IR touch remote control



### DISPLAY BLACK MASK

Display Black Mask with integrated Wi-Fi (App "Total Control 2.0")

# ISIDORA IDRO H2O

Ventilated pellet thermo-stove

Evolution  
*Life*

**A++** | 23,2 kW-N | 20,0 kW-H<sub>2</sub>O | 665 m<sup>3</sup>

## CHARACTERISTICS



- Air relief valve
- Upper room ventilation with dedicated motor, excludable
- Output smoke outlet possibilities: rear aligned
- Pressure transducer and display pressure value indication
- Combustion chamber in thick steel
- Ergonomic handle
- Door fire and brazier in cast iron
- Hermetic tank
- Combustion chamber probe
- Shell and tube exchanger (manual cleaning)
- Thermal and pressure safety
- Wide fire vision
- Expansion tank
- Safety valve 3 bar
- Extractable ash drawer

## ECODESIGN



Download  
Technical Sheet



SCAN ME

## TECHNICAL DATA

**Nominal power (min-max)**  
6,9 - 23,2 kW-N

**Power given back to water (min-max)**  
5,5 - 20,0 kW-H<sub>2</sub>O

**Efficiency (min-max)**  
91,2 - 91,5 %

**Hourly consumption (min-max)**  
1,6 - 5,3 kg/h

**Dimensions (LxHxD)**  
596 x 1243 x 708 mm

**Net weight**  
235 kg

**Fumes flue diameter (Ø)**  
100 mm B

**Tank total capacity**  
~38 kg / ~61 ℓ

**Power absorption (min-max)**  
65 - 85 W

**Operating pressure (bar)**  
3 bar

## TECHNOLOGY

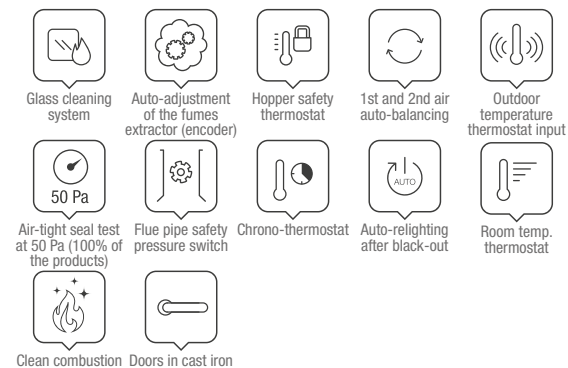

## COLOUR CHOICES

Finish in majolica and painted sheet metal



Ivory

Bordeaux

## STANDARD EQUIPMENT



### REMOTE CONTROL

Backlit IR touch remote control



### DISPLAY BLACK MASK

Display Black Mask with integrated Wi-Fi (App "Total Control 2.0")

# PELLET BOILERS

Evolution  
*Life*

Saving, comfort  
and technology



>> **THE LATEST GENERATION IGNITION SYSTEM**  
**FAST:** For immediate warmth in your home, always and everywhere

⚙️ **PWM PUMP AUTOMATICALLY MANAGED BY THE ELECTRONIC CARD**  
**SIMPLE:** Relax, the performance of your system is self-adjusting

≡ **NEW ELECTRONICS FOR CONNECTION TO THE PLANT'S EXPANSION CARD**  
**FLEXIBLE:** Maximum flexibility in the management of comfort in the rooms

📱 **HOME CONTROL SOLUTION**  
**INNOVATIVE:** Always in contact with your stove, even when you are away from home

🔔 **SELF-CLEANING BRAZIER**  
**CONVENIENT:** your stove cleans itself

💧 **OPTIMISED COMBUSTION**  
**EFFICIENT:** Reduces the waiting time for relighting, ensuring optimal combustion

# PR20

Pellet boiler with ash extractor

**A+** | 20,0 kW-N | 20,0 kW-H<sub>2</sub>O | 573 m<sup>3</sup>

## CHARACTERISTICS

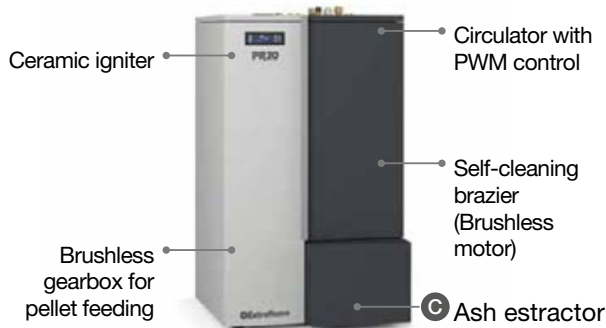

- A** Hydraulic connections at the top
- B** Output smoke outlet possibilities:
  - rear, left lateral
  - Air relief valve
  - Minimum pellet tank level probe
  - Combustion chamber in thick steel
  - Combustion chamber probe
  - Door fire and brazier in cast iron
  - Thermal and pressure safety
  - Shell and tube exchanger (automatic cleaning)
  - Front pellet tank feeding
  - Expansion tank
  - Wheels to facilitate movement
  - Safety valve 3 bar
  - **Innovative adaptive system to adjust and even the combustion air inlet**
- C** Ash extractor

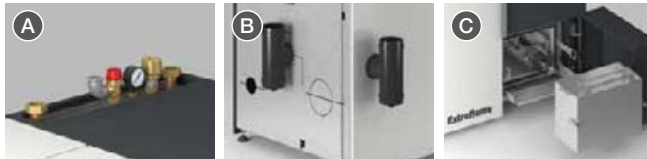

## TECHNICAL DATA

**Nominal power (min-max)**  
5,7 - 20,0 kW-N

**Power given back to water (min-max)**  
5,7 - 20,0 kW-H<sub>2</sub>O

**Efficiency (min-max)**  
88,4 - 92,4 %

**Hourly consumption (min-max)**  
1,4 - 4,6 kg/h

**Dimensions (LxHxD)**  
822 x 1398 x 817 mm

**Net weight**  
310 kg

**Fumes flue diameter (Ø)**  
100 mm B/LH side

**Tank total capacity**  
~75 kg / ~119 ℓ

**Power absorption (min-max)**  
60 - 65 W

**Operating pressure (bar)**  
3 bar

## TECHNOLOGY

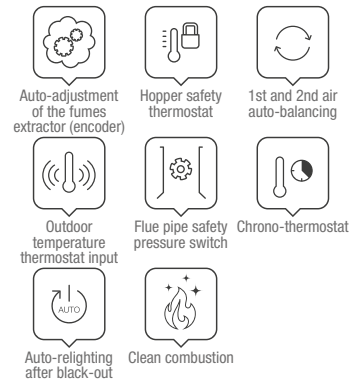

## ECODESIGN



Download  
Technical Sheet



SCAN ME

## COLOUR CHOICES

High temperature painted steel covering



Light grey / Dark grey

## STANDARD EQUIPMENT



**DISPLAY BLACK MASK**  
Display Black Mask with integrated Wi-Fi  
(App "Total Control 2.0")



**PLANT EXPANSION  
CARD KIT**

## OPTIONAL



**Automatic loading pellet  
stocking tank**  
(Total capacity Kg 300)

# PR30

Pellet boiler with ash extractor

**A+** | 30,0 kW-N | 30,0 kW-H<sub>2</sub>O | 860 m<sup>3</sup>

## CHARACTERISTICS



- A** Hydraulic connections at the top
- B** Output smoke outlet possibilities:
  - rear, left lateral
  - Air relief valve
  - Minimum pellet tank level probe
  - Combustion chamber in thick steel
  - Combustion chamber probe
  - Door fire and brazier in cast iron
  - Thermal and pressure safety
  - Shell and tube exchanger (automatic cleaning)
  - Front pellet tank feeding
  - Expansion tank
  - Wheels to facilitate movement
  - Safety valve 3 bar
  - **Innovative adaptive system to adjust and even the combustion air inlet**
- C** Ash extractor



## TECHNICAL DATA

**Nominal power (min-max)**  
8,9 - 30,0 kW-N

**Power given back to water (min-max)**  
8,9 - 30,0 kW-H<sub>2</sub>O

**Efficiency (min-max)**  
92,7 - 92,4 %

**Hourly consumption (min-max)**  
2,0 - 6,8 kg/h

**Dimensions (LxHxD)**  
892 x 1398 x 817 mm

**Net weight**  
325 kg

**Fumes flue diameter (Ø)**  
120 mm B/LH side

**Tank total capacity**  
~75 kg / ~119 ℓ

**Power absorption (min-max)**  
70 - 85 W

**Operating pressure (bar)**  
3 bar

## TECHNOLOGY

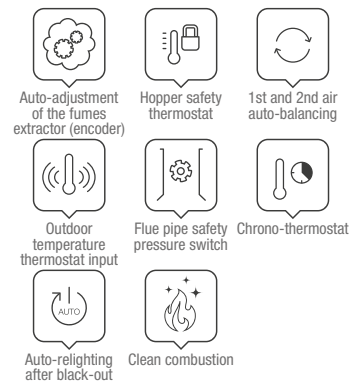

## ECODESIGN



Download  
Technical Sheet



SCAN ME

## COLOUR CHOICES

High temperature painted steel covering



Light grey / Dark grey

## STANDARD EQUIPMENT



### DISPLAY BLACK MASK

Display Black Mask with integrated Wi-Fi (App "Total Control 2.0")



### PLANT EXPANSION CARD KIT

## OPTIONAL



### Automatic loading pellet

stocking tank  
(Total capacity Kg 300)



**Glass cleaning system**  
A system of pre-heated air which removes any deposit from the fire-door glass.



**Extractable burn pot for easy cleaning**  
The burn pot's system of construction allows easy extraction for quick and complete cleaning.

## PELLET



**Auto-adjustment of the fumes extractor (encoder)**  
It keeps the RPM of the fumes motor constant, to ensure correct combustion of the product.

## WOOD-BURNING



**Hearth in Nordiker**  
La Nordica-Extraflame uses a special material called Nordiker for the production of hearth walls refractories.



**Post combustion**  
The combustion system developed by La Nordica-Extraflame allows, due to a secondary/tertiary air system, a post combustion which significantly reduces emissions.



**Hopper safety thermostat**  
Ensure always high safety standard, preventing the overheating of the product in case of anomaly.

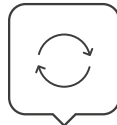

**1st and 2nd air auto-balancing**  
Primary and secondary air electronically balanced for an optimal combustion and thermal efficiency.



**Outdoor temperature thermostat input**  
The product interfaces with room temperature control devices (thermostat or contacts) to achieve the selected temperature in every room.



**Doors in cast iron**  
The high-quality cast-iron doors are made to last and ensure perfect sealing at all times.



**Automatic safety device**  
It is a safety device created to quickly reduce water temperature, according to rules in force. DSA valve not included.



**Air-tight seal test at 50 Pa (100% of the products)**  
All the air-tight products, or even those that have some "air-tight" components (like the hopper), are tested under high pressure at the end of the production line to ensure their safety and optimal performance.



**Flue pipe safety pressure switch**  
Checks the correct evacuation of the fumes and, in case of need, locks the loading of pellets, to avoid problems on the generator.



**Chrono-thermostat**  
Chronothermostat provided with temperature control divided in four daily slots for an optimal rooms management.



**Glass cleaning system**  
A system of pre-heated air which removes any deposit from the fire-door glass.



**Direct outdoor air intake (BBC)**  
Air intake system which draws fresh air from outside directly into the adjust system combustion regulation of the firebox of the appliance.



**Auto-relighting after black-out**  
Following a black out the appliance automatically re-starts after having carried out the scheduled auto-control.



**Room temp. thermostat**  
The room probe optimizes comfort and lowers noticeably the consumption.



**Clean combustion**  
Increases the combustion efficiency and the duration of parts subject to wear duration reducing at the same time the ordinary brazier cleaning.



**Outdoor air intake (ASC)**  
A particular connection system which allows to introduce air from the outside into the pre-heated environment around the fire-box.



**Radiant system (PRS)**  
High efficiency Heat exchanger system

# GENERAL PRODUCTS TABLE OF CONTENTS

Page no.	Article description	Finish Colour	DM186	Conto termico 2.0 (Coefficiente premiante)	Flamme Verte	DTA	BlmSchV	15a B-VG	Ecodesign
<b>PRESTIGE LINE</b>									
10	<b>ALASKA</b>	GLAZED BLACK				** Technical data may be subject to changes, approval pending			
6	DANTE	MATTE BLACK	★★★★	1,2	7★		✓	✓	✓
7	DANTE CON PORTALEGNA	MATTE BLACK	★★★★	1,2	7★		✓	✓	✓
2-3	LIU'	WHITE INFINITY BURGUNDY NATURAL STONE	★★★★	1,5	7★		✓	✓	✓
9	MILLY	WHITE INFINITY BURGUNDY	★★★★		7★		✓	✓	✓
16	<b>MIRKA</b>	BLACK NATURAL STONE DOVE GREY				** Technical data may be subject to changes, approval pending			
17	<b>MIRKA PLUS</b>	BLACK NATURAL STONE DOVE GREY				** Technical data may be subject to changes, approval pending			
12	MONOBLOCCO 1000 EVO		★★★★	1,5	7★		✓	✓	✓
11	<b>MONOBLOCCO 3LC</b>					** Technical data may be subject to changes, approval pending			
13	<b>MONOBLOCCO 90PA</b>		★★★★★	1,5	7★		✓	✓	✓
8	<b>NOVA FORNO</b>	MATT WHITE BURGUNDY	★★★★★	1,5	7★		✓	✓	✓
5	ORIANA	WHITE INFINITY ANTHRACITE BLACK NATURAL STONE	★★★★	1,5	7★		✓	✓	✓
15	SABRY	IVORY BRONZE BLACK	★★★★	1,5	7★		✓	✓	✓
4	TAHITI	ANTHRACITE BLACK	★★★★		7★		✓	✓	✓
4	TAHITI EPS	ANTHRACITE BLACK	★★★★	1,5	7★		✓	✓	✓
<b>EVOLUTION LINE</b>									
23	ANGELA EVO	WHITE BURGUNDY BLACK	★★★★	1,5	7★	✓	✓	✓	✓
34	ANGELA PLUS EVO	WHITE BURGUNDY BLACK	★★★★	1,5	7★	✓	✓	✓	✓
21	<b>ANGY</b>	WHITE BRONZE BLACK				** Technical data may be subject to changes, approval pending			
50	CALDAIA PR20	LIGHT GREY / DARK GREY	★★★★★	1,5	7★		✓	✓	✓
51	CALDAIA PR30	LIGHT GREY / DARK GREY	★★★★★	1,5	7★		✓	✓	✓
26	DEBBY	WHITE BLACK NATURAL STONE	★★★★	1,5	7★		✓	✓	✓
46	<b>EVELYNE IDRO 2.0</b>	WHITE BLACK NATURAL STONE WHITE GREY DOVE GREY	★★★★	1,5	7★		✓	✓	✓
45	FIANDRA IDRO EVO	PANNA	★★★★	1,5	7★		✓	✓	✓

# GENERAL PRODUCTS TABLE OF CONTENTS

Page no.	Article description	Finish Colour	DM186	Conto termico 2.0 (Coefficiente premiante)	Flamme Verte	DTA	BlmSchV	15a B-VG	Ecodesign
36	GABRIELLA PLUS	WHITE BRONZE NATURAL STONE	★★★★	1,5	7★	✓	✓	✓	✓
44	GUENDA IDRO	IVORY BRONZE DOVE GREY	★★★★	1,5	7★		✓	✓	✓
22	<b>ILARY</b>	WHITE BLACK					** Technical data may be subject to changes, approval pending		
35	<b>ILARY PLUS</b>	WHITE BLACK					** Technical data may be subject to changes, approval pending		
47	ISIDORA IDRO H16	WHITE BURGUNDY BRIGHT TORTORA	★★★★	1,5	7★		✓	✓	✓
48	ISIDORA IDRO H20	IVORY BURGUNDY	★★★★	1,5	7★		✓	✓	✓
29	<b>KATIA 11</b>	WHITE BRONZE DOVE GREY					** Technical data may be subject to changes, approval pending		
28	<b>KATIA 9</b>	WHITE BRONZE DOVE GREY					** Technical data may be subject to changes, approval pending		
27	MIETTA EVO	WHITE BURGUNDY	★★★★	1,5	7★	✓	✓	✓	✓
20	MOIRA EVO	WHITE BURGUNDY BLACK	★★★★	1,5	7★	✓	✓	✓	✓
31	<b>NORIS</b>	WHITE BRONZE DOVE GREY					** Technical data may be subject to changes, approval pending		
32	<b>NORIS LUX</b>	WHITE DOVE GREY					** Technical data may be subject to changes, approval pending		
39	<b>NORIS PLUS</b>	WHITE BRONZE DOVE GREY					** Technical data may be subject to changes, approval pending		
40	<b>NORIS PLUS LUX</b>	WHITE DOVE GREY					** Technical data may be subject to changes, approval pending		
24	PAMELA STEEL	BRONZE DOVE GREY	★★★★	1,5	7★	✓	✓	✓	✓
25	<b>PAMELA CRYSTAL - BLSC</b>	CRYSTAL BLSC	★★★★	1,5	7★	✓	✓	✓	✓
43	ROSANNA IDRO	IVORY BURGUNDY BRONZE	★★★★	1,5	7★		✓	✓	✓
37	SHARON PLUS	CRYSTAL NATURAL STONE	★★★★	1,5	7★	✓	✓	✓	✓
38	<b>SHARON PLUS STEEL</b>	CRYSTAL NATURAL STONE BLACK					** Technical data may be subject to changes, approval pending		
30	SINFONY	WHITE BRIGHT TORTORA	★★★★	1,5	7★	✓	✓	✓	✓
41	TERRY PLUS	WHITE BURGUNDY	★★★★	1,5	7★	✓	✓	✓	✓



# CERTIFICATES



Italian Regulation for the Environmental Certificate release of domestic solid fuels biomass room heaters (Classification from 1 up to 5 stars).

## **BlmSchV**

German regulations on controlling emissions.



Only for Italy: the Ministerial Decree 28/12/12, better known as “Conto Termino”, allows a specific incentive in case of replacement of old appliances by new ones with certain characteristics

## **15a B-VG**

Compliance with article 15 of the Austrian federal constitutional law on environmental protection measures.



French trademark of the ADEME agency for the environment and the energy. The products “Flamme Verte” approved guarantee the best high energy performances and respect for the environment.

## **ECODESIGN**

European certification defining the ecodesign guidelines for biomass products.



Certification issued by the French Scientific and Technical Building Centre – CSTB – for watertight devices tested in watertight installation conditions.

## **MFB**

Only for Germany: The products is ready to be connected to a multiply chimney connection , just when the installation is made in accordance with requirements of the regional and national standards, and when observed the norms DIN EN 13384-2, DIN V 1816-1, DIN 18896 and MFeuV-2007 (Muster-Feuerungsverordnung), and that the district chimney sweeper has checked and approved the correct installation.



Certification issued by the German Federal Office for Economics and Export Control to promote the efficient use of biomass energy.

# LIST OF FUNCTIONS OF PELLET PRODUCTS

	SABRY	MIRKA	MIRKA PLUS	ANGY	MOIRA EVO	ANGELA EVO	PAMELA	ILARY	DEBBY	MIETTA EVO	KATIA 9	KATIA 11	SINFONY	NORIS / NORIS LUX	ILARY PLUS	ANGELA PLUS EVO	GABRIELLA PLUS	SHARON PLUS	SHARON PLUS STEEL	NORIS PLUS / NORIS PLUS LUX	TERRY PLUS	FOSANNA IDRO	GUENDA IDRO	FIANDRA IDRO EVO	EVELYNE IDRO 2.0	ISIDORA IDRO H16	ISIDORA IDRO H20	PR20	PR30	
Prestige line	✓	✓	✓																											
Evolution line				✓	✓	✓	✓	✓	✓	✓	✓	✓	✓	✓	✓	✓	✓	✓	✓	✓	✓	✓	✓	✓	✓	✓	✓	✓	✓	
Airtight product				✓	✓	✓	✓	✓	✓	✓	✓	✓	✓	✓	✓	✓	✓	✓	✓	✓	✓	✓	✓	✓	✓					
Airtight tank	✓	✓	✓		✓	✓	✓	✓	✓	✓	✓	✓	✓	✓	✓	✓	✓	✓	✓	✓	✓	✓	✓	✓		✓	✓			
Radio remote control with handheld device				✓	✓	✓	✓	✓	✓	✓	✓	✓	✓		✓	✓			✓	✓				✓	✓					
<b>Easy Setup</b>	✓	✓	✓	✓	✓	✓	✓	✓	✓	✓	✓	✓	✓	✓	✓	✓	✓	✓	✓	✓	✓	✓	✓	✓	✓	✓	✓	✓	✓	
<b>Easy Control</b>	✓	✓	✓	✓	✓	✓	✓	✓		✓	✓	✓	✓	✓	✓	✓	✓	✓	✓	✓		✓	✓	✓	✓					
<b>Flow Performance Control (Huba)</b>		✓	✓											✓							✓						✓	✓		
<b>Self Control</b>	✓	✓	✓	✓	✓	✓	✓	✓	✓	✓	✓	✓	✓	✓	✓	✓	✓	✓	✓	✓	✓									
<b>Automatic</b>				✓				✓			✓	✓			✓			✓	✓											
<b>Air Zone Control</b>			✓												✓			✓	✓	✓										
Self-cleaning brazier										✓	✓	✓	✓	✓						✓	✓		✓	✓	✓	✓	✓	✓	✓	
Brushless pellet loading motor										✓	✓	✓	✓	✓						✓	✓		✓	✓	✓	✓	✓	✓	✓	
Ceramic glow plug	✓	✓					✓		✓	✓	✓	✓	✓	✓				✓	✓	✓	✓	✓	✓	✓	✓	✓	✓	✓	✓	
"5-star" brazier	✓	✓												✓						✓								✓	✓	
EGR	✓	✓																												
<b>Pro Air Setup</b>	✓	✓	✓					✓			✓	✓		✓	✓					✓										
On/off ventilation					✓					✓			✓					✓	✓	✓	✓	✓	✓	✓	✓	✓	✓	✓		
Removable ducting			✓												✓	✓	✓	✓	✓	✓	✓	✓								
Total Control app	2.0	3.0	3.0	3.0	2.0	2.0	2.0	3.0	2.0	2.0	3.0	3.0	2.0	3.0	3.0	2.0	2.0	2.0	2.0	3.0	2.0	2.0	2.0	2.0	2.0	2.0	2.0	2.0	2.0	
<b>Home automation integration with "Alexa"</b>		✓	✓	✓				✓			✓	✓		✓	✓					✓										
Wi-Fi as standard (built in on radio board - SHARON type)				✓				✓			✓	✓			✓			✓	✓						✓					
Option of connecting with radio room probe				✓				✓							✓															
Stelle DM 186/2017	4	5	5	4	4	4	4	4	4	4	4	4	4	5	4	4	4	4	4	4	5	4	4	4	4	4	4	4	5	5

## **EASY SETUP**

The *Easy Setup* function allows the user to easily configure the stove so that it can operate as efficiently as possible with most types of pellets available on the market. It ensures optimum performance in terms of yield for each type of pellet.

## **EASY CONTROL**

In order to function, a stove must be connected to a system that has a flue and an external air inlet. Not all systems are the same as they depend on the physical characteristics of the building in which they are used: consequently, the operating conditions of the stove can vary considerably depending on the system itself. Thanks to the Easy Control function, the stove operates under optimal conditions even in difficult situations, minimising unwanted effects such as condensation and poor combustion, and it can also help to keep the glass of the stove door cleaner.

## **FLOW PERFORMANCE CONTROL (FPC)**

The FPC system keeps the supply of combustion air constant at all times, thus ensuring that combustion characteristics remain the same. In this way, maximum stove efficiency is achieved even when the system conditions (stove+flue pipe) change.

## **SELF CONTROL**

All Extraflame products use an automatic power management system (maximum power or minimum power) that allows the stove to reach the room temperature set by the user. Therefore, with the Self Control management mode, the desired temperature is reached in the shortest possible time.

## **AUTOMATIC**

Automatic is the evolution of the Self Control function. The stove accurately and continuously regulates the power output in order to reach and maintain the temperature set by the user. This translates into improved thermal and acoustic comfort and reduced consumption.

## **AIR ZONE CONTROL (AZC)**

The Air Zone Control feature is exclusive to products with a dedicated motor for ducting. The AZC function ensures maximum heat output to the ducting when the room in which the stove is installed has reached the set temperature. Therefore, in this mode, maximum comfort is achieved in the ducted area and consumption is significantly reduced when the set temperature is reached in the main room.

## **PRO AIR SETUP**

New setup for ventilation mappings. It allows the user to choose between 4 different room ventilation modes:  
Off = Fan off. N.B. Mode only available for models that have this setting option.  
Quiet = Fan speed is reduced for noise reduction (compared to Regular).  
Regular = Default configuration.  
Boost = Fan speed is increased compared to Regular in order to maximise ventilation air flow.

## **INTEGRAZIONE DOMOTICA "ALEXA"**

With this extra feature, the stove can be controlled via the "Alexa" (Amazon) voice assistant. This operation requires an Internet connection + the new Total Control 3.0 app: therefore, the product must have the "Grey" module or have this function integrated in the board/display set up for the 3.0. app.

## NOTE

- Due to printing reasons the reproduction of colours has to be considered only indicative.
- The fuel quantity (weight) inside the hopper and the hour consumption can change depending on the type of pellet which is used.
- All the figures were measured using approved pellets in compliance with EN ISO 17225-2.
- Facing tones and characteristics are subject to slight variations because they are natural products.
- The manufacturer reserves the right to change the products without any previous notice.
- The La Nordica-Extraflame products can be covered by industrial property rights (such as patents, designs and trademarks) owned by La Nordica-Extraflame exclusively. It is strictly forbidden to violate these rights as for removing, cancelling or corrupting the trademarks impressed on the products and impressing others.
- m<sup>3</sup> that can be heated: the data is indicative. For the generator to be sized correctly, contact a skilled technician/designer.
- Before the purchase, ask your reseller all the information regarding the appliance. One must also bear in mind all laws and national, regional, provincial and town council Standards present in the country in which the appliance has been installed, as well as the instructions contained in this manual.
- The images contained in this document are for product illustration purposes only and do not represent indications for the performance or technical characteristics of the same.
- The data in the catalogue can be rounded off to the first decimal.
- La Nordica-Extraflame products are approved to work with 230V 50Hz power supply only. The use with different voltages and / or frequencies supply can compromise the functionality and safety of the products.

## ENERGY LABEL



As of 1st January 2018 the Energy Labelling Regulation came into force also for all the biomass heating appliances, both roomheater appliances and appliances designed to heat the water for central heating and domestic hot water.

This directive, in accordance with the regulations of the European Union, will assign an Energy Efficiency Class (from G up to A++) providing the buyers with information about the consumption and the efficiency

## LEGEND

**kW-N:** Nominal thermal power (kW)

**kW-H<sub>2</sub>O:** Power given back to water (kW)

**m<sup>3</sup>:** Heatable m<sup>3</sup> (30 kcal/h x m<sup>3</sup>)

**%:** Efficiency (%)

**kg-l:** Feed box Total capacity (kg-l)

**kg/h:** Hourly consumption (kg/h)

**Ø mm:** Smoke outlet diameter (mm)

T = Top

B = Back

RH side = Right side

LH side = Left side

**Dim. LxHxD:** Dimensions LxHxD (mm)

**kg:** Net weight (kg)

**W:** Electric consumption (W)

**bar:** Working pressure (bar)



**NORDICA**<sup>®</sup>  
Extraflame

FEEL AT HOME  
*A natural choice*





Only for Italy

*Seal issued by the German Institute ITQF on the basis of an online survey, representative of the Italian population, conducted in August and September 2021, which collected 265,000 customer ratings from 1616 companies, against payment of an annual licence. For more information see [www.istituto-qualita.com/campioni-del-servizio](http://www.istituto-qualita.com/campioni-del-servizio)*



**La Nordica S.p.A.**

Via Summano, 104 • 36030 Montecchio Precalcino - Vicenza - Italy  
Tel. +39 0445 804000 • Fax +39 0445 804040  
info@lanordica.com

**Extraflame S.p.A.**

Via dell'Artigianato, 12 • 36030 Montecchio Precalcino - Vicenza - Italy  
Tel. +39 0445 865911 • Fax +39 0445 865912  
info@extraflame.it

[www.lanordica-extraflame.com](http://www.lanordica-extraflame.com)

9300035-001

